



Rocket Door Frames

INSTRUCTIONS



FRAME INSTALLATION VIDEO
VÍDEO DE INSTALACIÓN DEL MARCO



DOOR INSTALLATION VIDEO
VÍDEO DE INSTALACIÓN DE PUERTAS

► H MEASUREMENT FROM FINISHED FLOOR LEVEL
► H MEDIDA DESDE EL NIVEL DEL SUELO ACABADO

- Install at finished floor level.
Instalar a nivel del suelo terminado

- To obtain a sliding pocket door with two leaves it's necessary to join n°2 single door kits. (P.10)
Para obtener una puerta doble hay que juntar dos sistemas (p.10)

- See page 3 for dimensions
Véase la página 3 para las dimensiones

| DOOR PANEL PANEL PUERTA | | STUD MONTANTES | OVERALL DIMENSIONS MEDIDA TOTAL | | | |
|----------------------------|-----|-------------------|------------------------------------|---------|-----------------------------|---------|
| | | | SINGLE DOOR PUERTA ÚNICA | | DOUBLE DOOR PUERTA DOBLE | |
| DW | DH | | W | H | W | H |
| 24" | 80" | 2x4 | 48 5/8" | 82 3/4" | 97 1/4" | 82 3/4" |
| 28" | 80" | 2x4 | 56 1/4" | 82 3/4" | 112 5/8" | 82 3/4" |
| 30" | 80" | 2x4 | 60 3/8" | 82 3/4" | 120 3/4" | 82 3/4" |
| 32" | 80" | 2x4 | 64 3/8" | 82 3/4" | 128 3/4" | 82 3/4" |
| 34" | 80" | 2x4 | 68 3/8" | 82 3/4" | 136 3/4" | 82 3/4" |
| 36" | 80" | 2x4 | 72 1/4" | 82 3/4" | 144 5/8" | 82 3/4" |

CAUTION ATENCIÓN



Please follow the instructions carefully as they have been designed to help you, don't skip any pages or stages as you may miss important steps. Use the correct tools and relevant protective clothing/eyewear. Gloves are essential as there may be some sharp edges. A pair of saw horses would be useful for the assembly.

Por favor, siga las instrucciones cuidadosamente ya que se hicieron para ayudarle, no se salte ninguna página o etapa, ya que puede perder pasos importantes. Utilice las herramientas correctas y la ropa/gafas de protección pertinentes. Los guantes son esenciales ya que puede haber algunos bordes afilados. Un par de caballetes serían útiles para el montaje.

TOOLS REQUIRED HERRAMIENTAS NECESARIAS

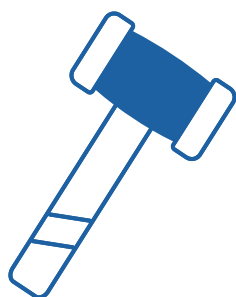

TORX T15



PH 2
PZ 2

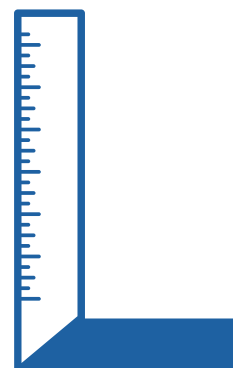

OVERALL DIMENSIONS MEDIDA TOTAL

The Rocket Pocket kit will adapt to almost any stud dimension **HOWEVER**, the stud immediately above the frame must be 2x4. You can add layers of drywall to this to then obtain the wall thickness you require. Bare in mind the jamb dimensions will change accordingly.

El kit Rocket Pocket se adaptará a casi cualquier dimensión de montantes, SIN EMBARGO, el montante inmediatamente superior a la estructura debe ser de 2x4. Se pueden añadir placas de yeso a esto para luego obtener el espesor de la pared que usted requiere. Tenga en cuenta que las dimensiones de las jambas cambiarán de consecuencia.

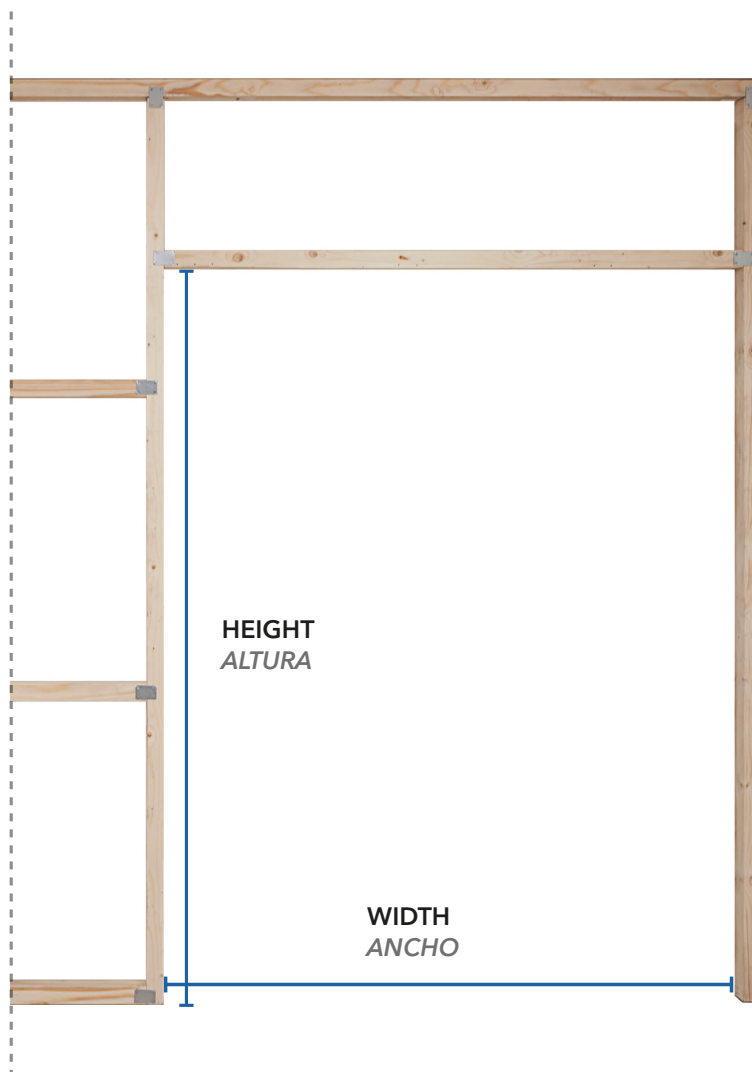

► H MEASUREMENT FROM FINISHED FLOOR LEVEL

► H MEDIDA DESDE EL NIVEL DEL SUELO ACABADO

| DOOR PANEL PANEL PUERTA | | STUD MONTANTES | OVERALL DIMENSIONS MEDIDA TOTAL | | | |
|----------------------------|-----|-------------------|------------------------------------|---------|-----------------------------|---------|
| DW | DH | | SINGLE DOOR PUERTA ÚNICA | | DOUBLE DOOR PUERTA DOBLE | |
| DW | DH | | W | H | W | H |
| 24" | 80" | 2x4 | 48 5/8" | 82 3/4" | 97 1/4" | 82 3/4" |
| 28" | 80" | 2x4 | 56 1/4" | 82 3/4" | 112 5/8" | 82 3/4" |
| 30" | 80" | 2x4 | 60 3/8" | 82 3/4" | 120 3/4" | 82 3/4" |
| 32" | 80" | 2x4 | 64 3/8" | 82 3/4" | 128 3/4" | 82 3/4" |
| 34" | 80" | 2x4 | 68 3/8" | 82 3/4" | 136 3/4" | 82 3/4" |
| 36" | 80" | 2x4 | 72 1/4" | 82 3/4" | 144 5/8" | 82 3/4" |

CONTENTS - Each kit contains

CADA KIT CONTIENE:

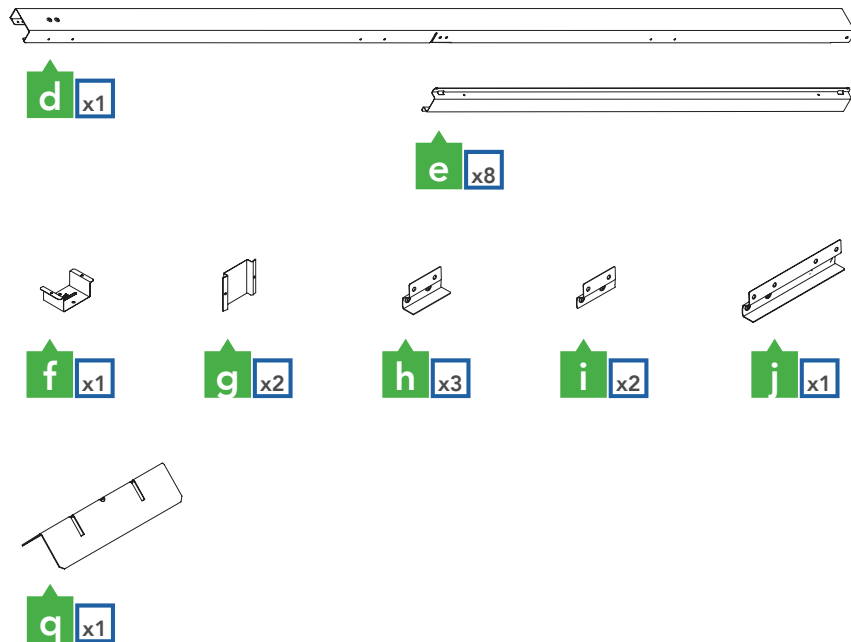

FRAME PACK

PAQUETE MARCO

m x1

n x1

p x24

r x72

s x1

t x4

u x2

DOOR PACK

PAQUETE PUERTA

aa x2

ff x1

bb x2

gg x1

cc x2

hh x2

dd x8

ii x2

ee x1

ll x2

1 POSITION VERTICALS (A & B) CORRECTLY PÓSICION MONTANTES VERTICALES CORRECTA

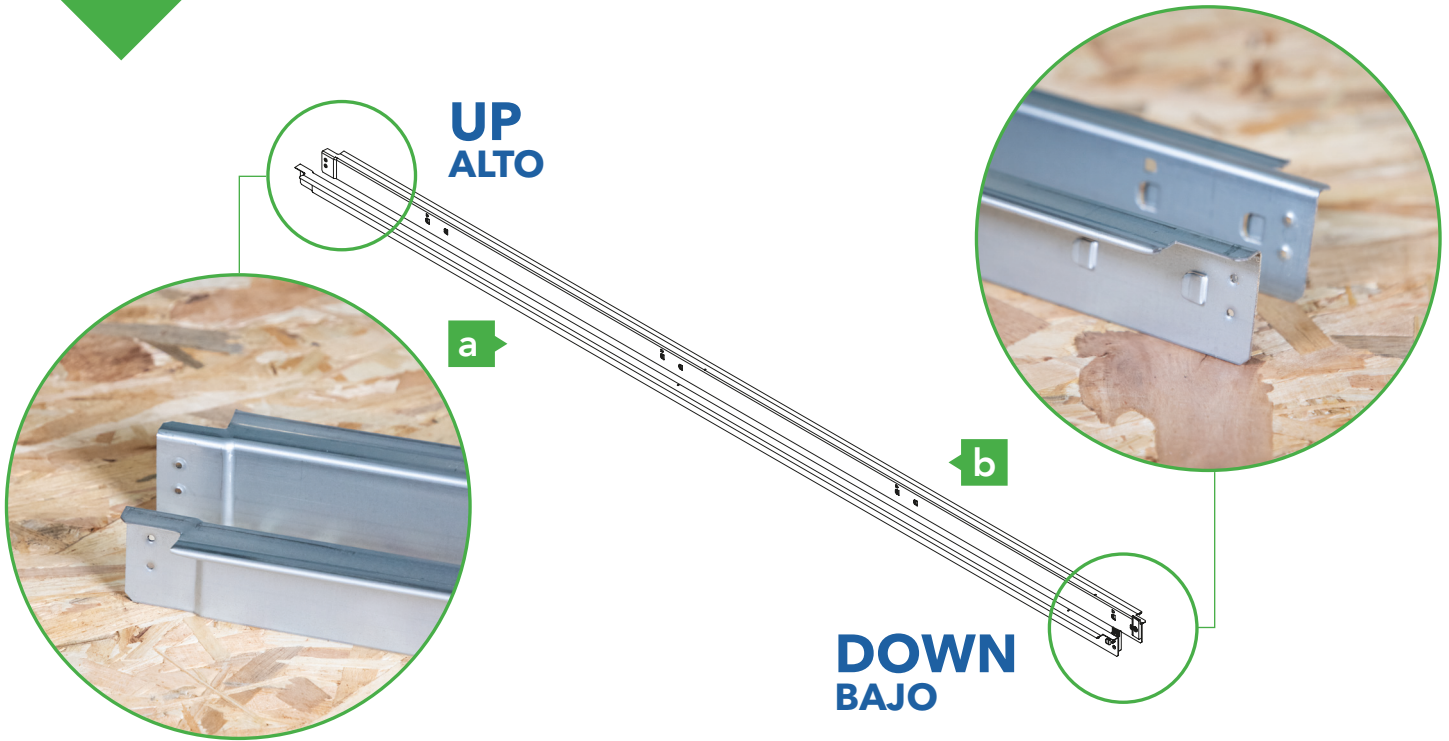

2 CHOOSING THE DOOR GUIDE - For WOODEN doors only ELECCIÓN DE LA GUÍA DE LA PUERTA - Sólo para puertas de madera

DOOR THICKNESS
ESPESOR DE LA PUERTA

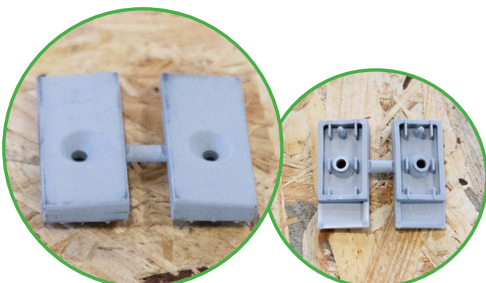
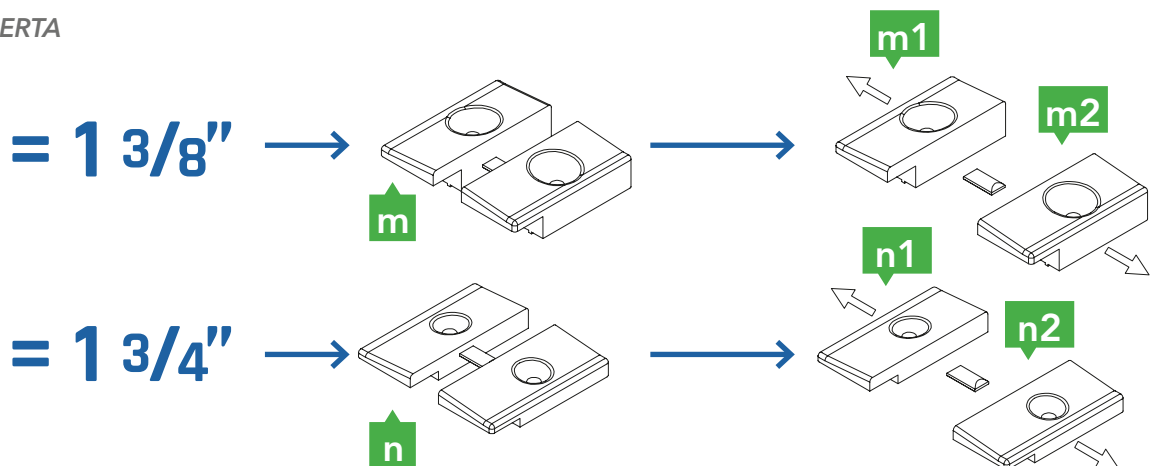

3

EXAMPLE: ATTACHING 1 3/8" DOOR GUIDES M1 AND M2

EJEMPLO: FIJACIÓN GUIA PUERTA DE 1 3/8" DE ESPESOR- M1 Y M2

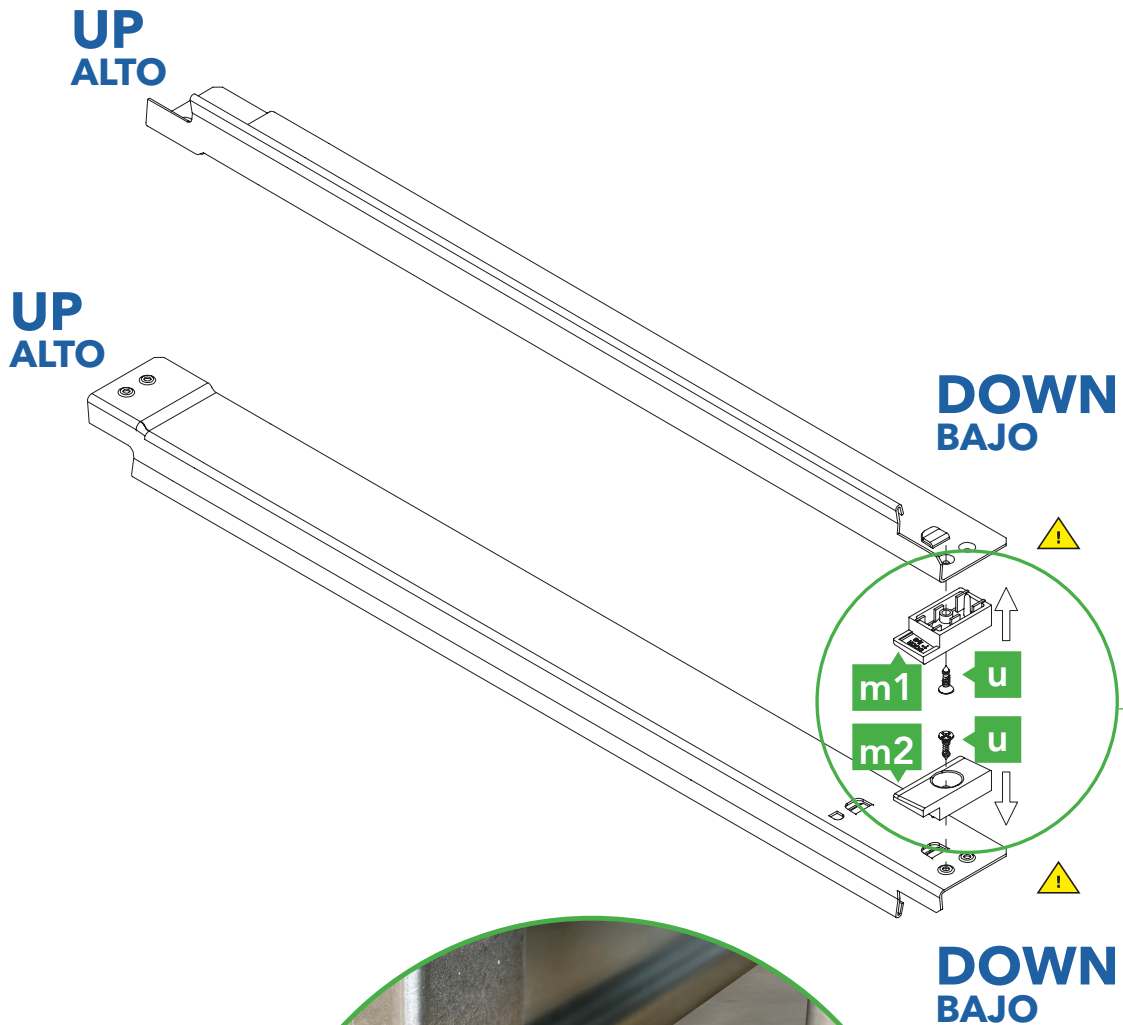

!

CAUTION: the narrowest part should be mounted facing upwards.

ATENCIÓN: La parte más estrecha debe montarse mirando hacia arriba.



!

Screw in at the holes.
Atornillar los agujeros.

4

CONNECTING VERTICALS a & b FIJACIÓN VERTICALES a y b

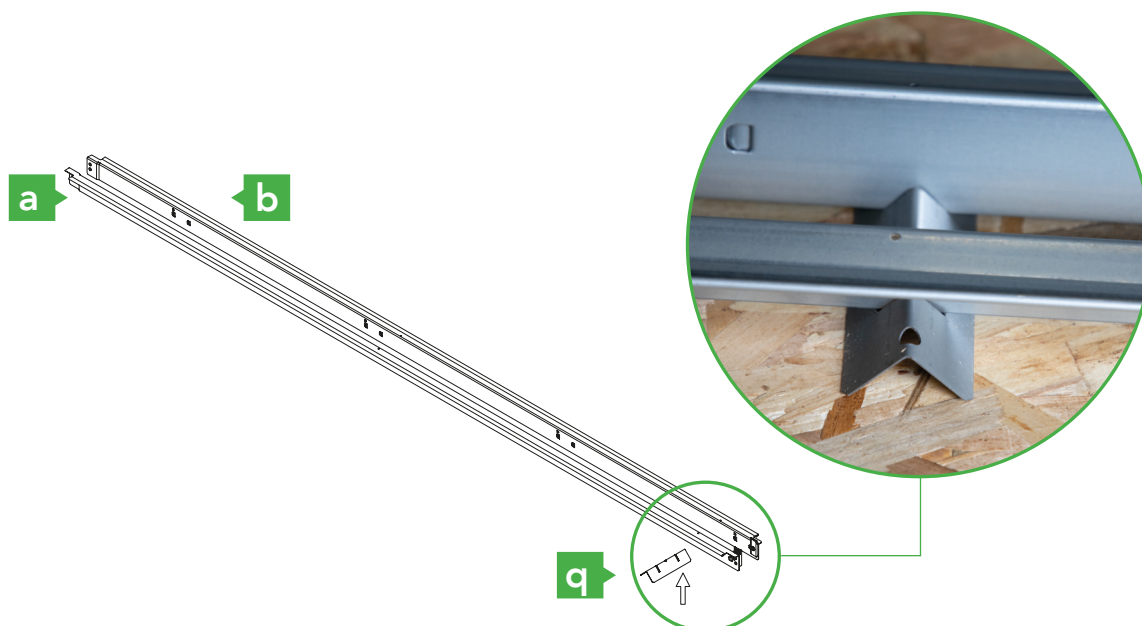

5

ATTACHING THE SPACERS FIJACIÓN DE LOS ESPACIADORES

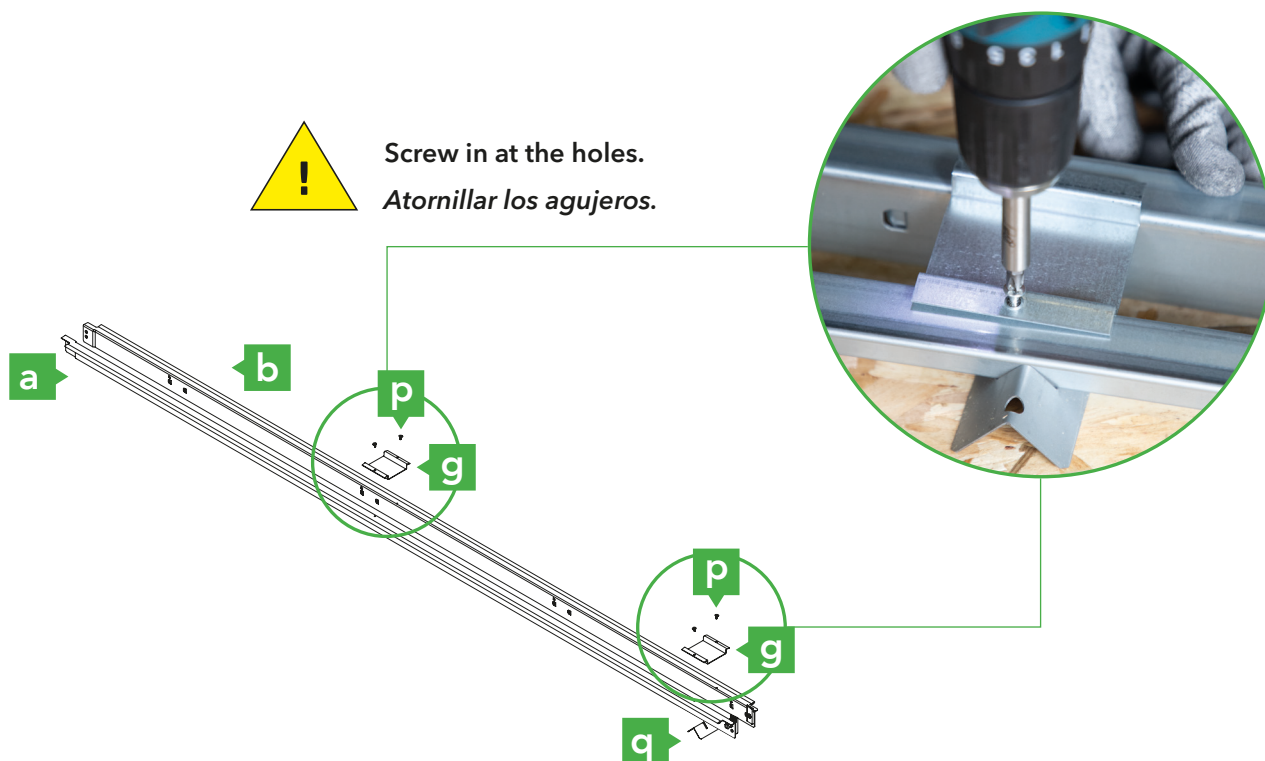

6

HORIZONTAL BARS "E" SNAPPING INTO "a/b/c" COSTILLAS HORIZONTALES "e" CLIPAR EN "a/b/c"

REAR POSTERIOR

FRONT FRONTAL



CLICK!
Make sure both
snaps click!
*Verifica el
engance "click".*

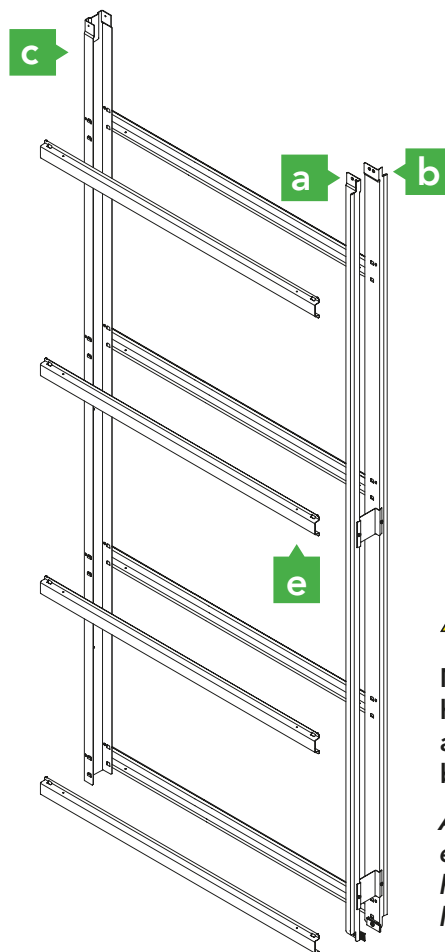

It is necessary to
use the hammer.

*Si es necesario
utilice el martillo.*



Make sure
horizontals "e"
are installed on
both sides.

*Assegura el
engance de los
horizontales en
los dos lados.*

7 ATTACHING BRACKET f FIJACIÓN PLETINA "f"

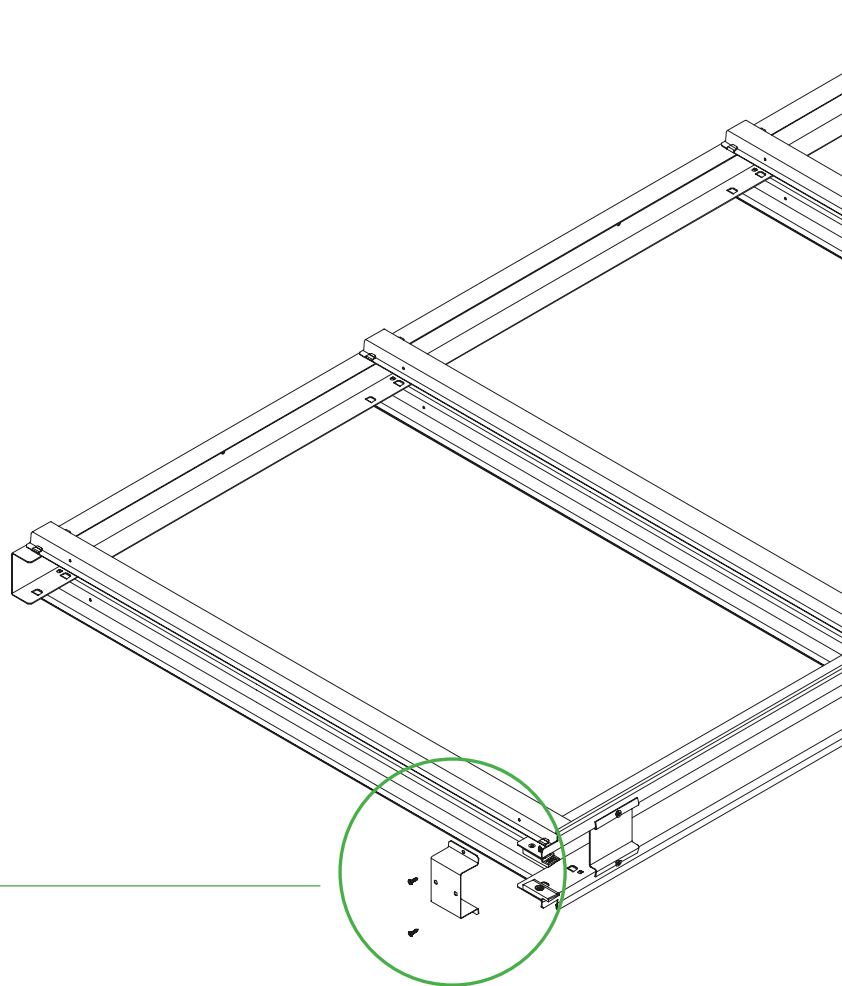
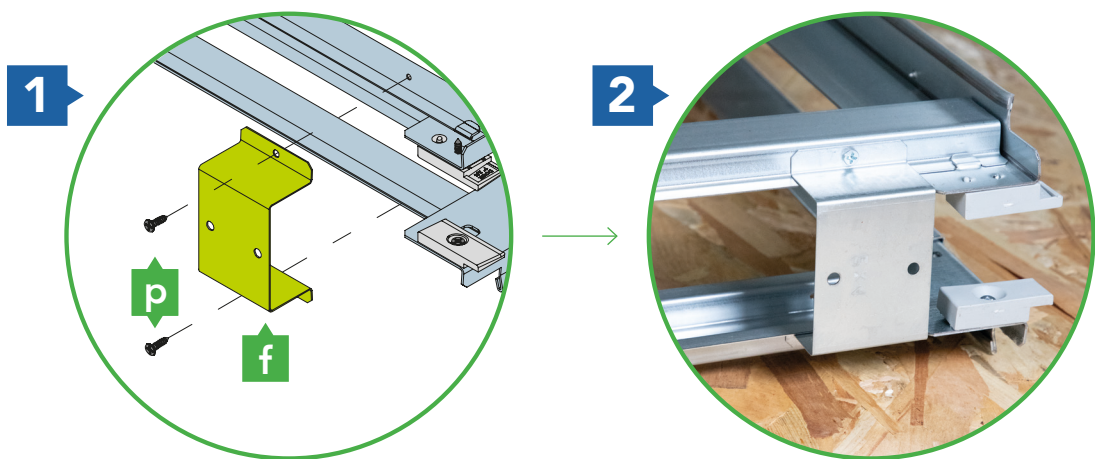

8

FIXING TOP BRACKETS TO THE TRACK FIJACIÓN SOPORTES SUPERIORES EN LA GUIA

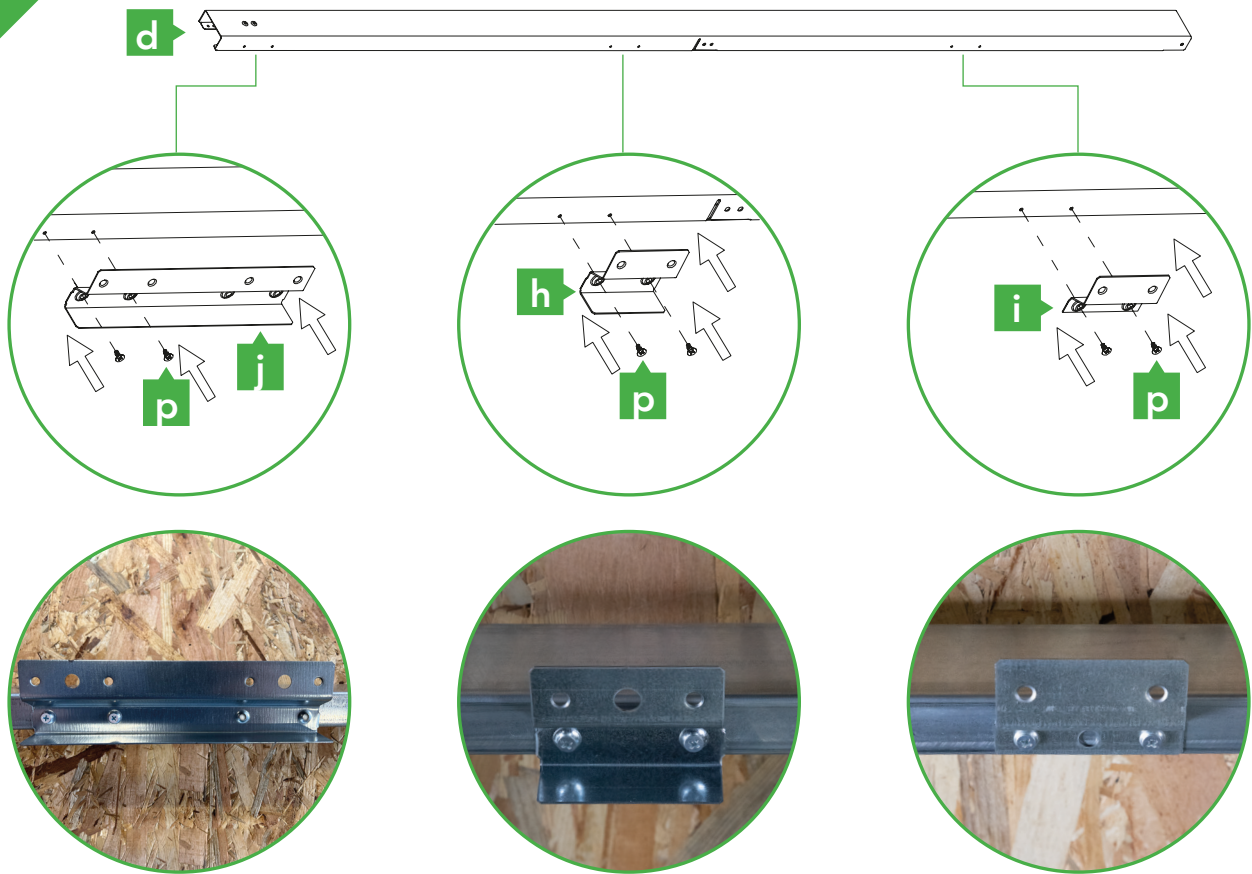

Mind this step if assembling a DOUBLE Tenga en cuenta este paso si monta una doble

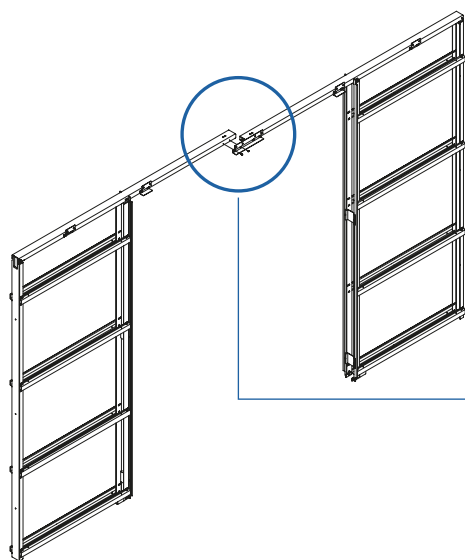

Bracket "j" is installed differently on double doors.

Los soportes superiores se montan de forma diferente en caso de doble puertas.

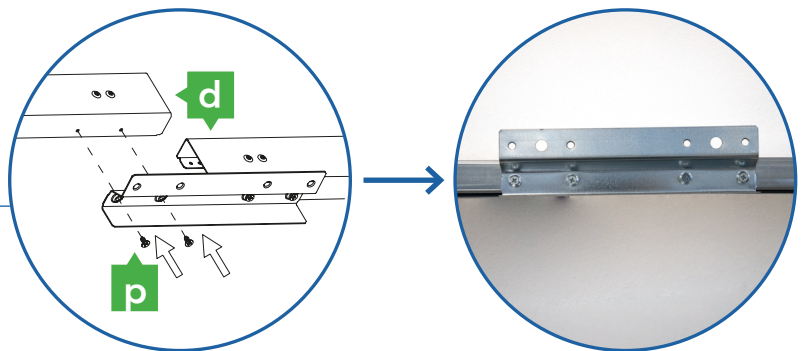
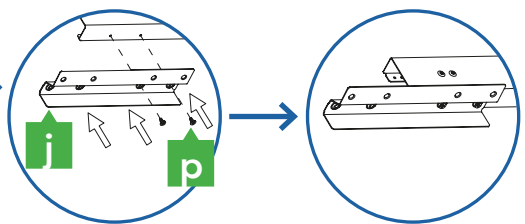

Double doors installation continues on page 17
Instrucciones de montaje doble puertas siguen a pagina 17

9

FIXING TRUCK IN TO THE FRAME FIJACIÓN DE LA GUIA AL MARCO

FRONT
FRENTE

REAR
POSTERIOR

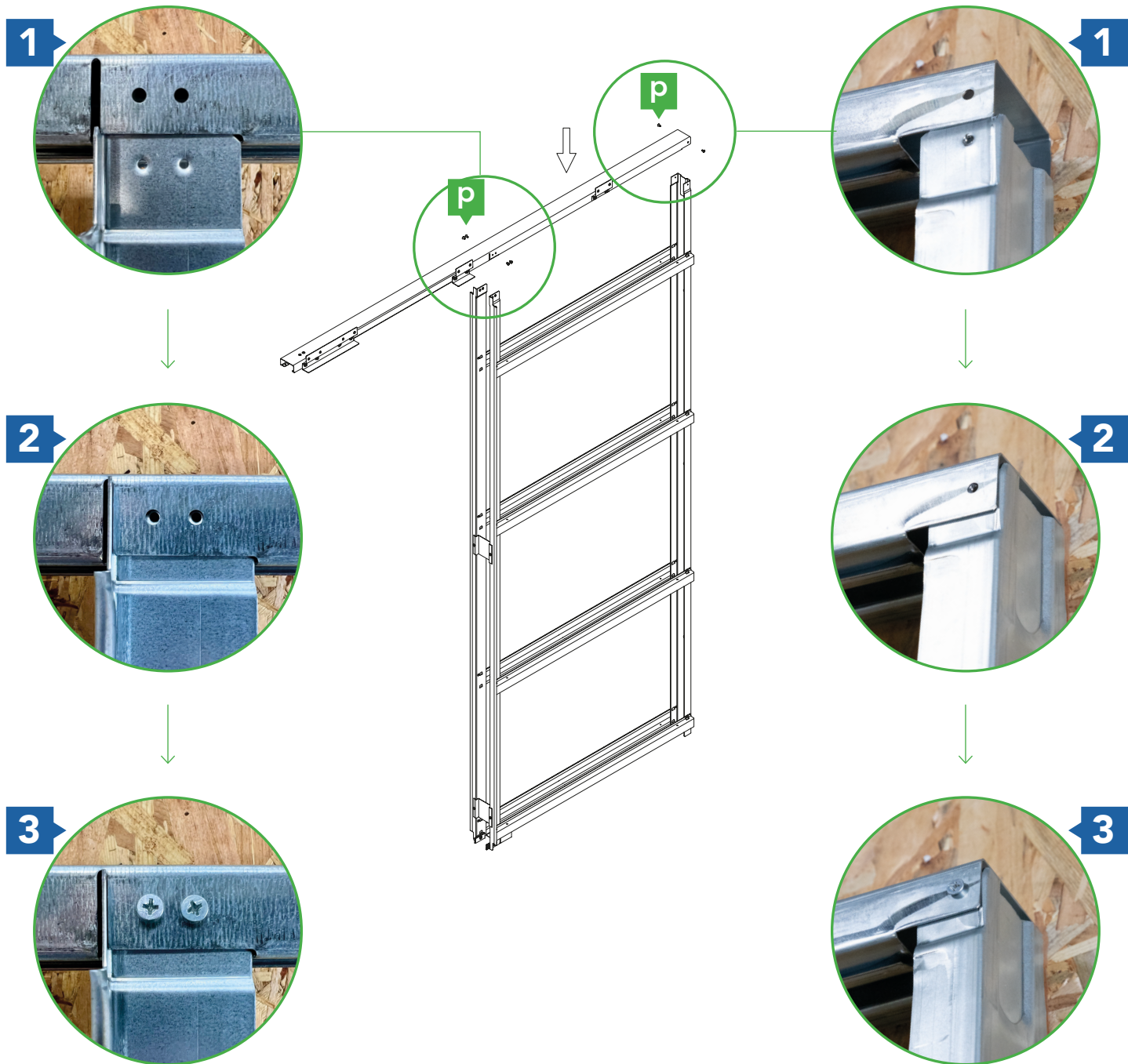

10

INSTALLING INTO STUDWORK INSTALACIÓN EN LA URDIMBRE

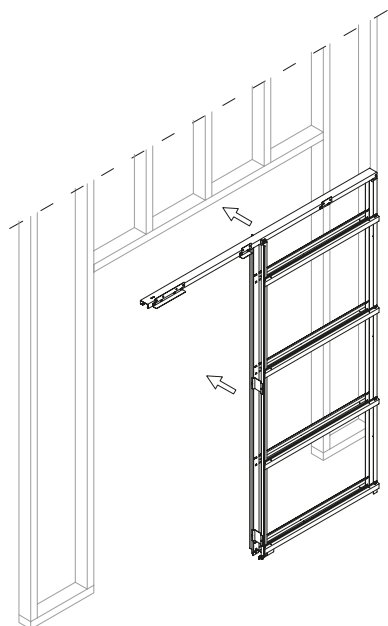

Place the frame
into studwork

*Posicionar el
marco en el
urdimbre*

11

SECURE THE BRACKETS ON THE OTHER SIDE FIJAR LOS SOPORTES EN EL OTRO LADO

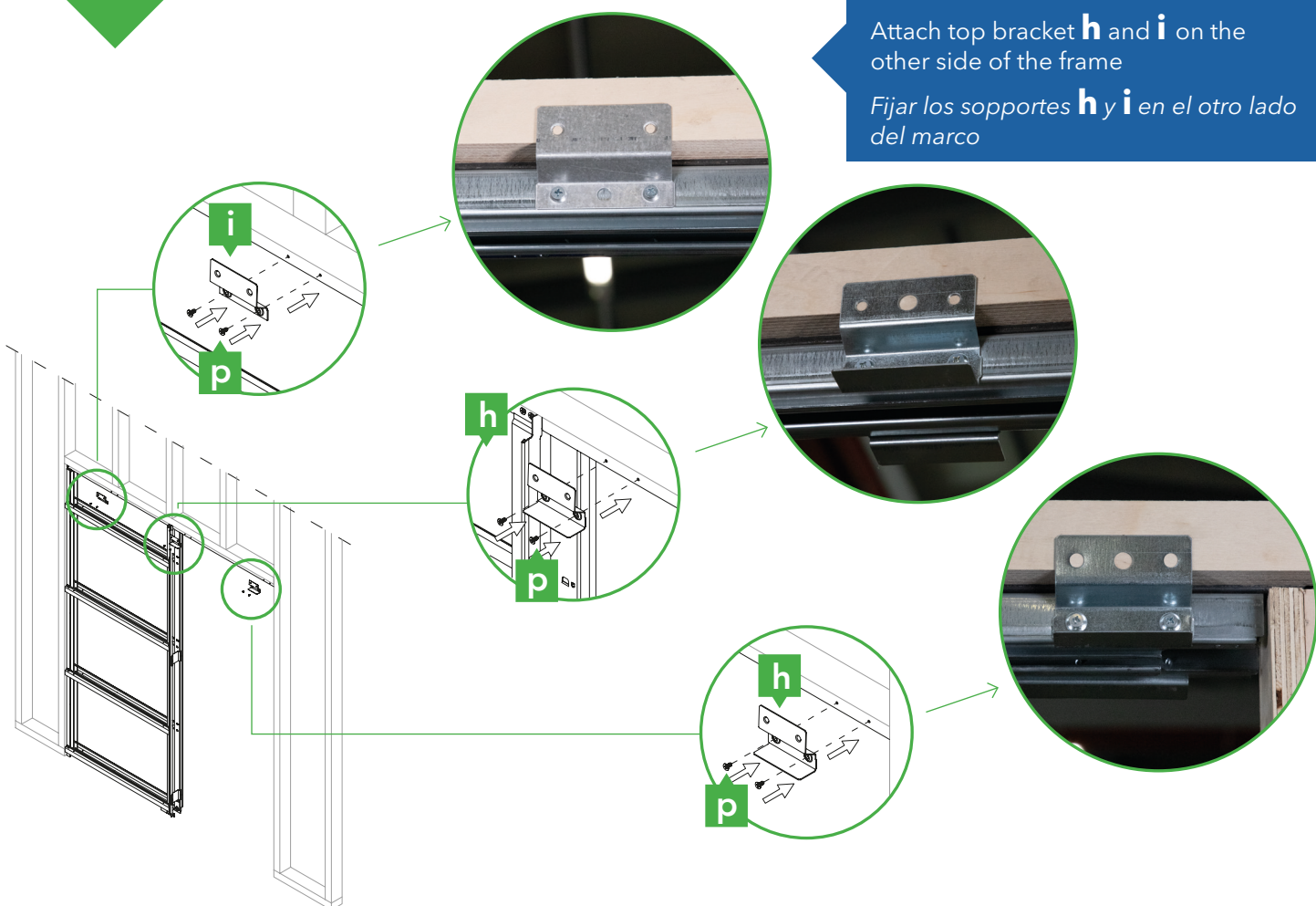

Attach top bracket **h** and **i** on the
other side of the frame

*Fijar los soportes **h** y **i** en el otro lado
del marco*

12

INSTALLING INTO STUDWORK INSTALACIÓN EN LA URDIMBRE

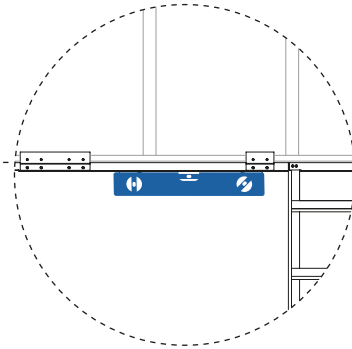
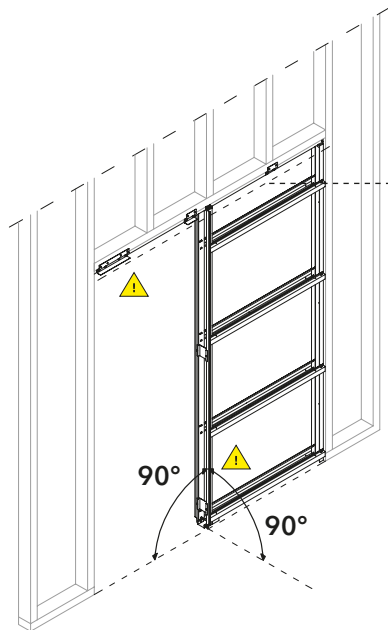

Ensure frame is plumb and square.

Comprobar la plomada y la escuadra del marco.

13

ATTACH THE BRACKETS TO THE STUDWORK FIJACIÓN DE LOS SOPORTES AL URDIMBRE

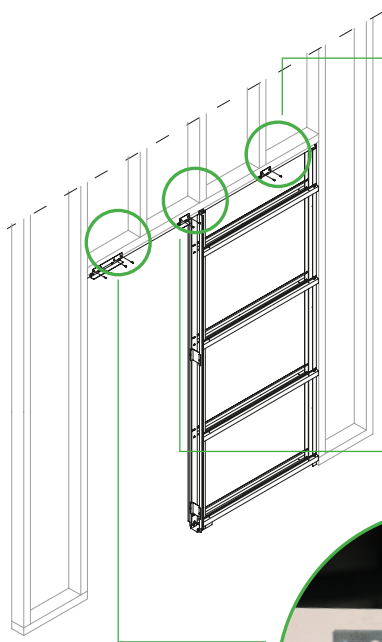

Screws Not Supplied
Tornillos No Suministrados

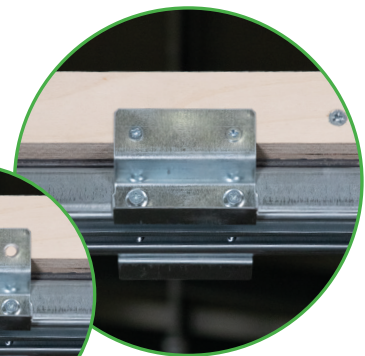
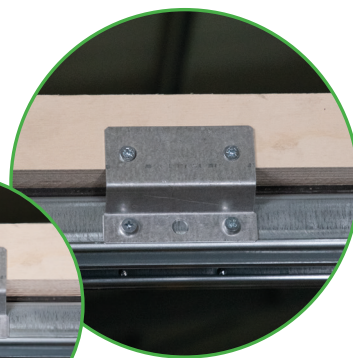
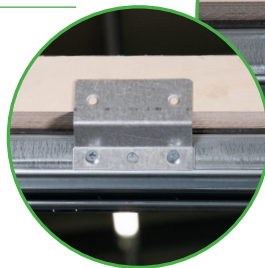

Screws Not Supplied
Tornillos No Suministrados



Screws Not Supplied
Tornillos No Suministrados

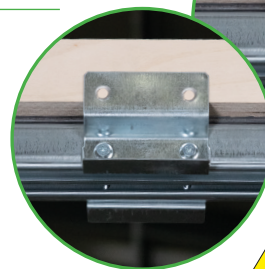
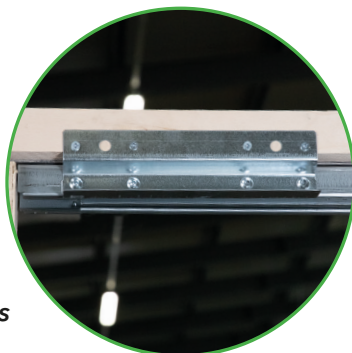

14

INSTALLING INTO STUDWORK INSTALACIÓN EN LA URDIMBRE

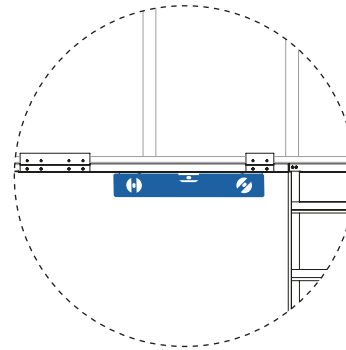
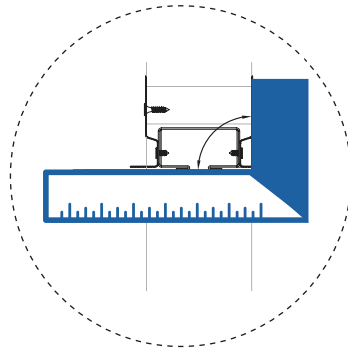
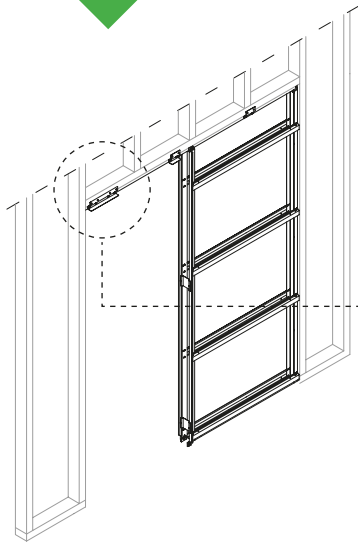

**SINGLE
DOOR
PUERTA
SIMPLE**



Ensure frame is plumb and squadre
Comprobar la plomada y la escuadra del marco

15

ATTACH THE BRACKETS TO THE OTHER SIDE FIJAR LOS SOPORTES EN EL OTRO LADO

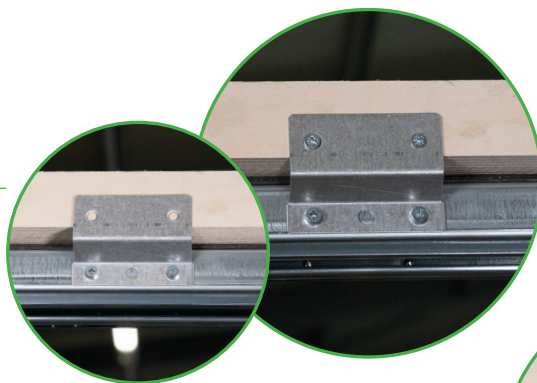
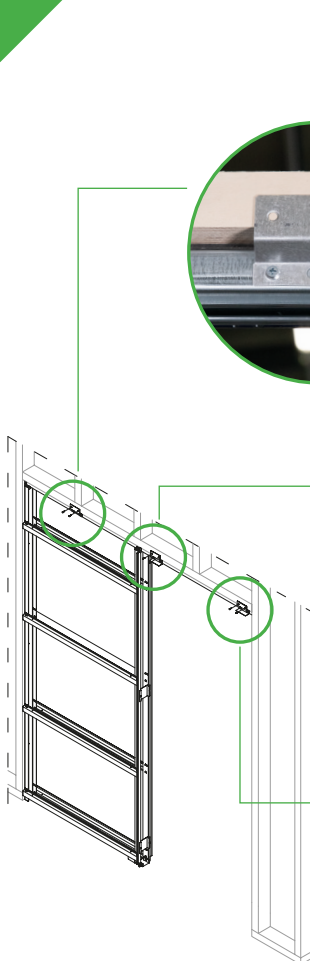

Screws
Not Supplied
*Tornillos No
Suministrados*

Screw brackets to other side of studwork ensuring the frame remains level.

Atornillar los soportes superiores al urdimbre aseguran que el marco se mantiene en el nivel.

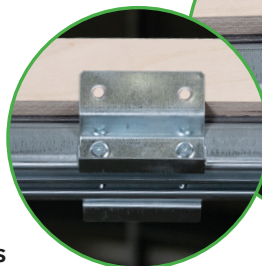

Screws
Not Supplied
*Tornillos No
Suministrados*



Screws
Not Supplied
*Tornillos No
Suministrados*

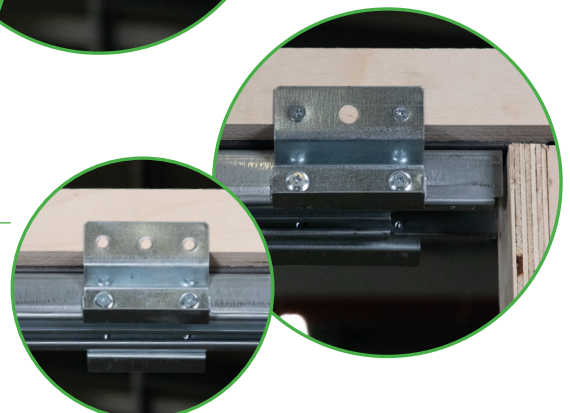

16

ATTACH THE POCKET TO THE FLOOR USING BRACKET f FIJAR EL MARCO AL SUELO ATRAVÉS LA PLETINA "f"

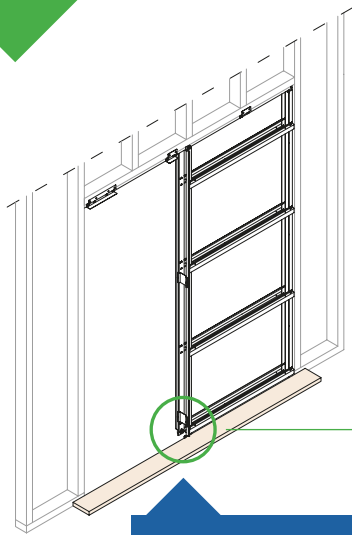

 **Level**

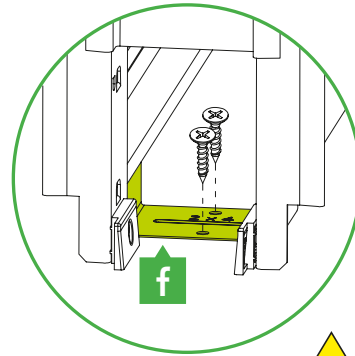

Screw the **f** bracket to the floor.
*Atornillar la pletina **f** al suelo.*



Ensure frame is plumb and square.
Comprobar la plomada y la escuadra del marc.



Screws Not Supplied
Tornillos no suministrados.

Place a straight edge along the bottom of the frame and ensure it is inline with the stud work.

Coloque una regla a lo largo de la parte inferior del marco y asegúrese de que está en línea con el urdimbre.

17

ATTACH THE POCKET TO THE BACK USING THE REAR POST FIJAR EL MARCO PARTE TRASERA, A TRAVÉS DEL MONTANTE DE LA URDIMBRE

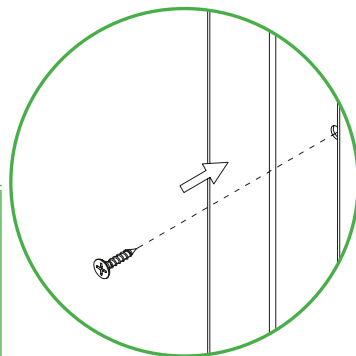
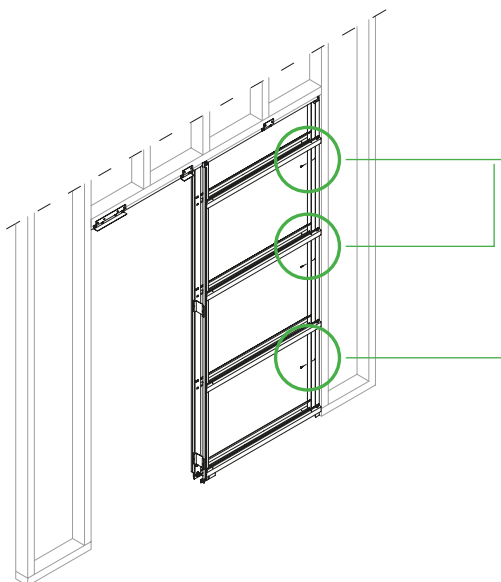

Not Supplied.
No suministrados.



Screw pocket rear vertical to studwork securely.

Atornillar firmemente la vertical trasera del marco al montante de la urdimbre.

Carefully clean the track **once secured.**

limpie con cuidado la guía una vez fijada.



18

SCREW IN THE ACTIVATOR OF THE DOUBLE SLOW MOTION ATORNILLAR EL ACTIVADOR DE LA DOBLE CÁMARA LENTA

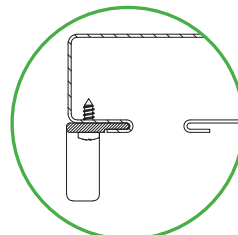
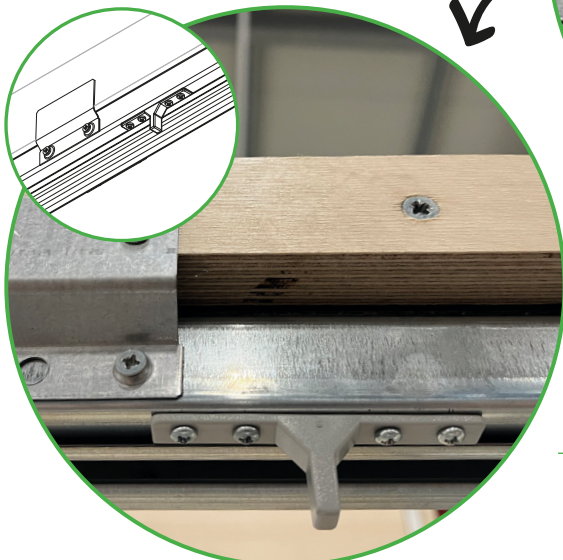
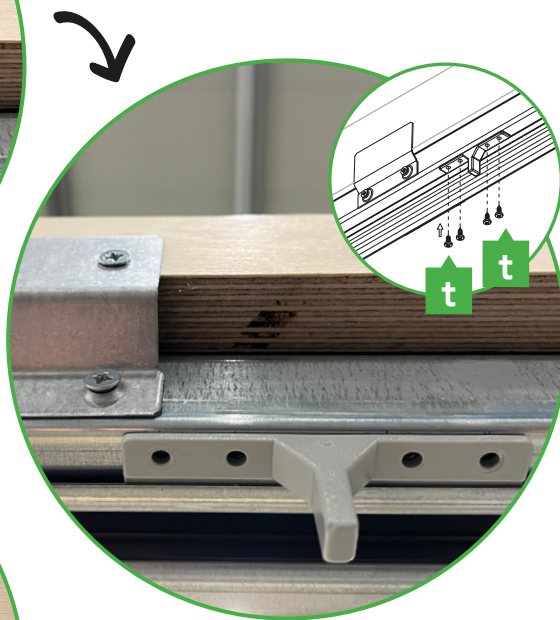
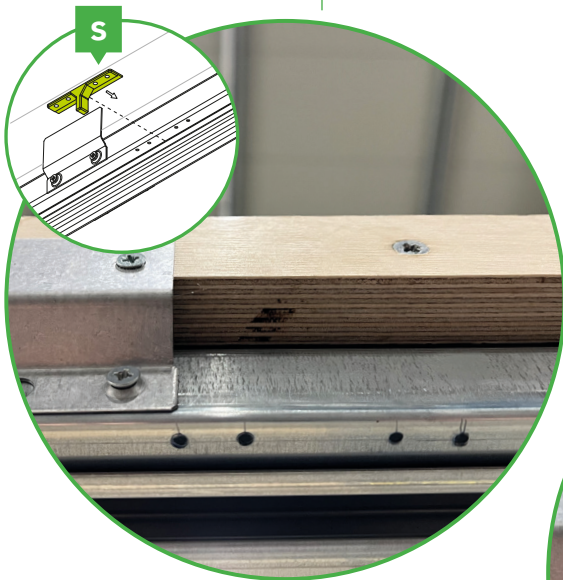
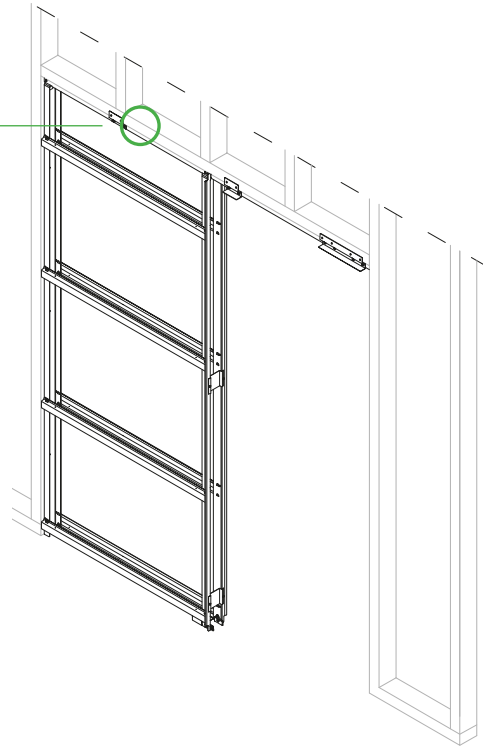

CAUTION: if the activator is not screwed in now, it will be necessary to cut the drywall to install it later. The activator will be used to install our double slow motion in the future.

ATENCIÓN: Si el activador no se atornilla ahora será necesario cortar la placa de yeso para instalarlo más tarde. El activador se utilizará para instalar nuestro doble movimiento lento en el futuro.

INSTRUCTIONS for

DOUBLE DOOR PUERTA DOBLE

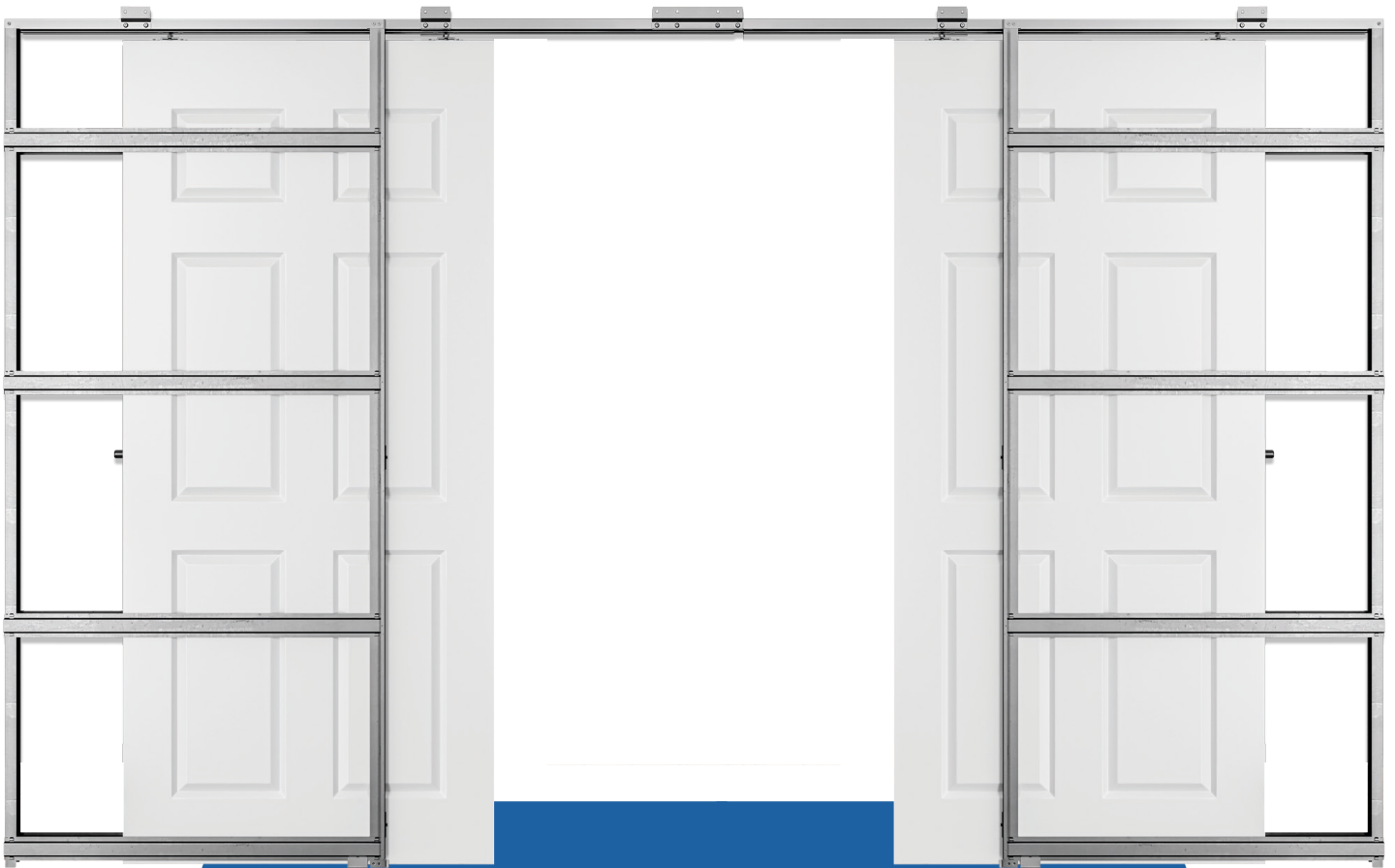

Follow the next pages and discover how to build up a double door from two singles.

Sigue las siguientes páginas y descubre cómo construir una puerta doble a partir de dos simples.

19

INSTALLING INTO STUDWORK INSTALACIÓN EN LA URDIMBRE

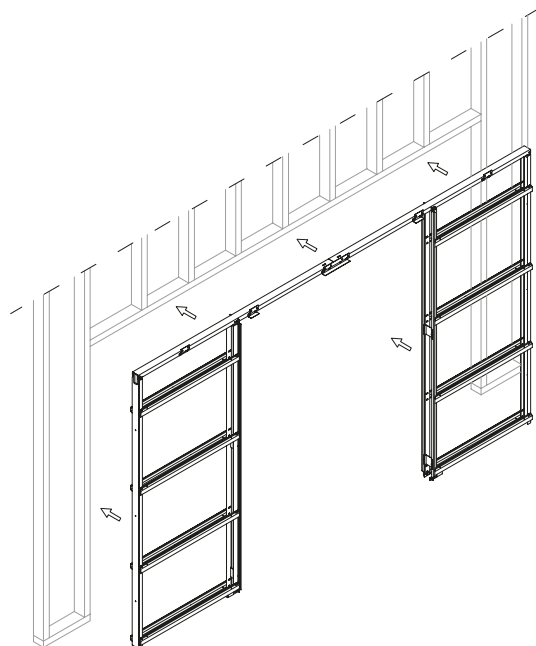

Place the frame into studwork

Posicionar el marco en el urdimbre

19.1

SECURE THE BRACKETS ON THE OTHER SIDE FIJAR LOS SOPORTES EN EL OTRO LADO

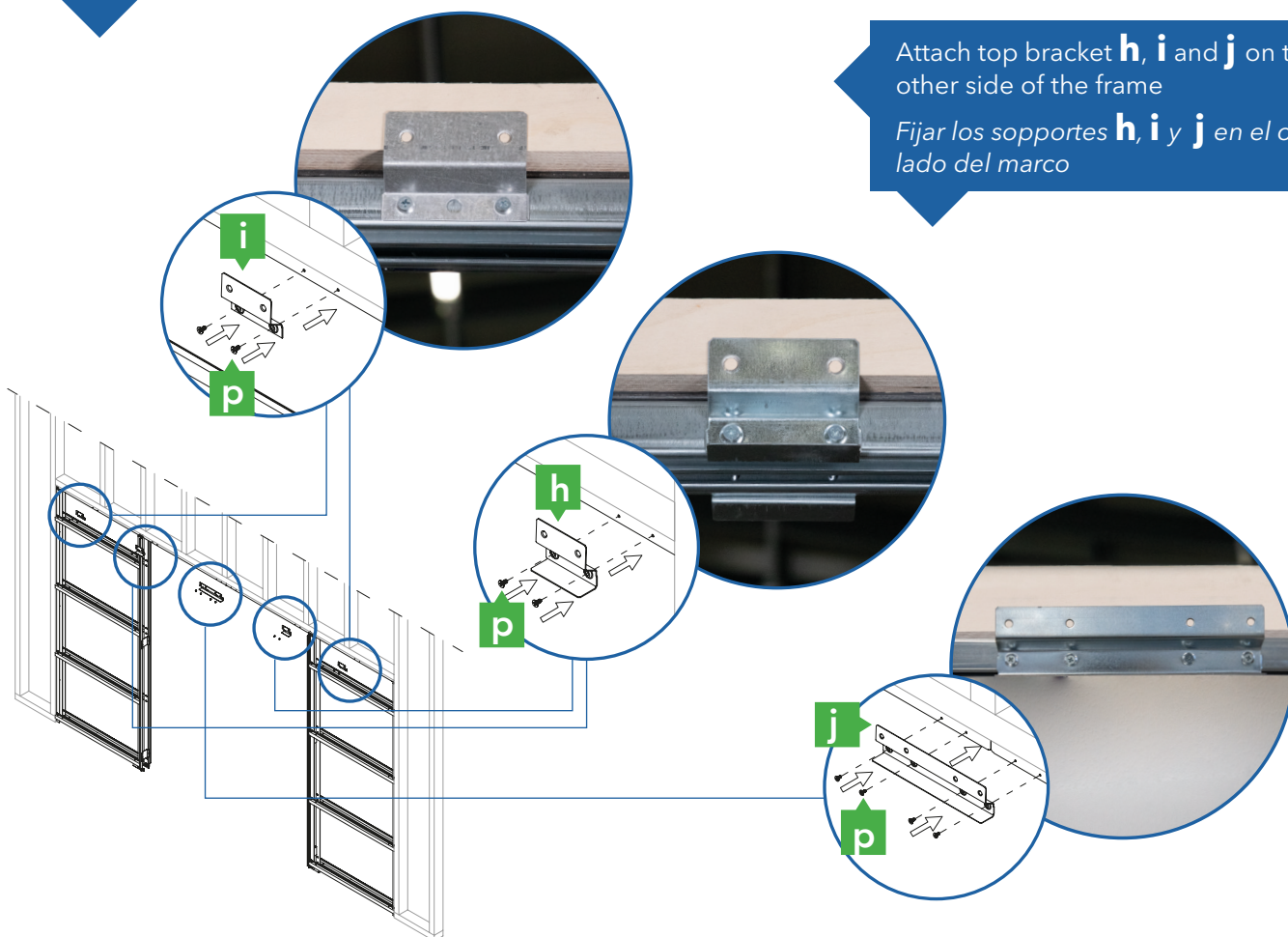

Attach top bracket **h**, **i** and **j** on the other side of the frame

*Fijar los soportes **h**, **i** y **j** en el otro lado del marco*

19.2 DOUBLE DOOR PUERTA DOBLE

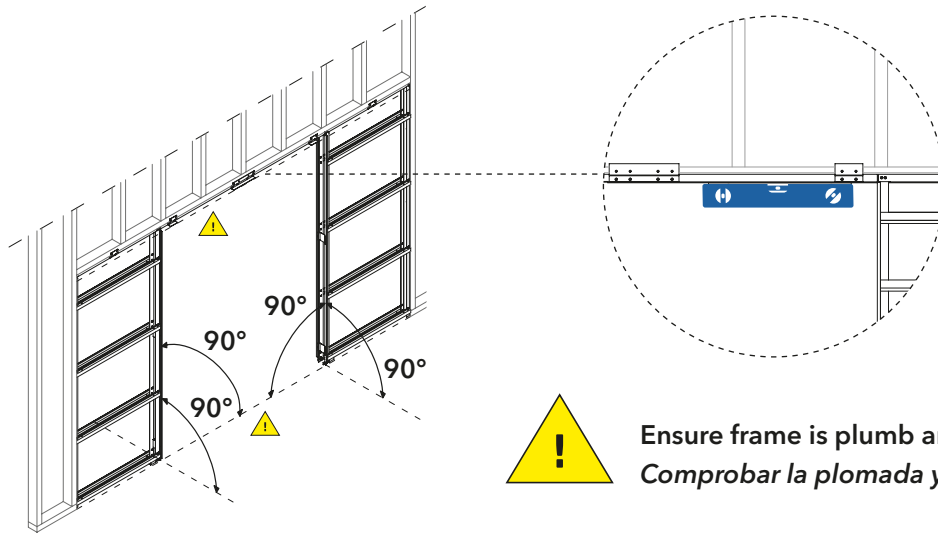

19.3 ATTACH THE BRACKET TO THE STUDWORK ATORNILLAR LOS SOPORTES AL URDIMBRE

Screw brackets to one side studwork
Atornillar los soportes superiores al urdimbre

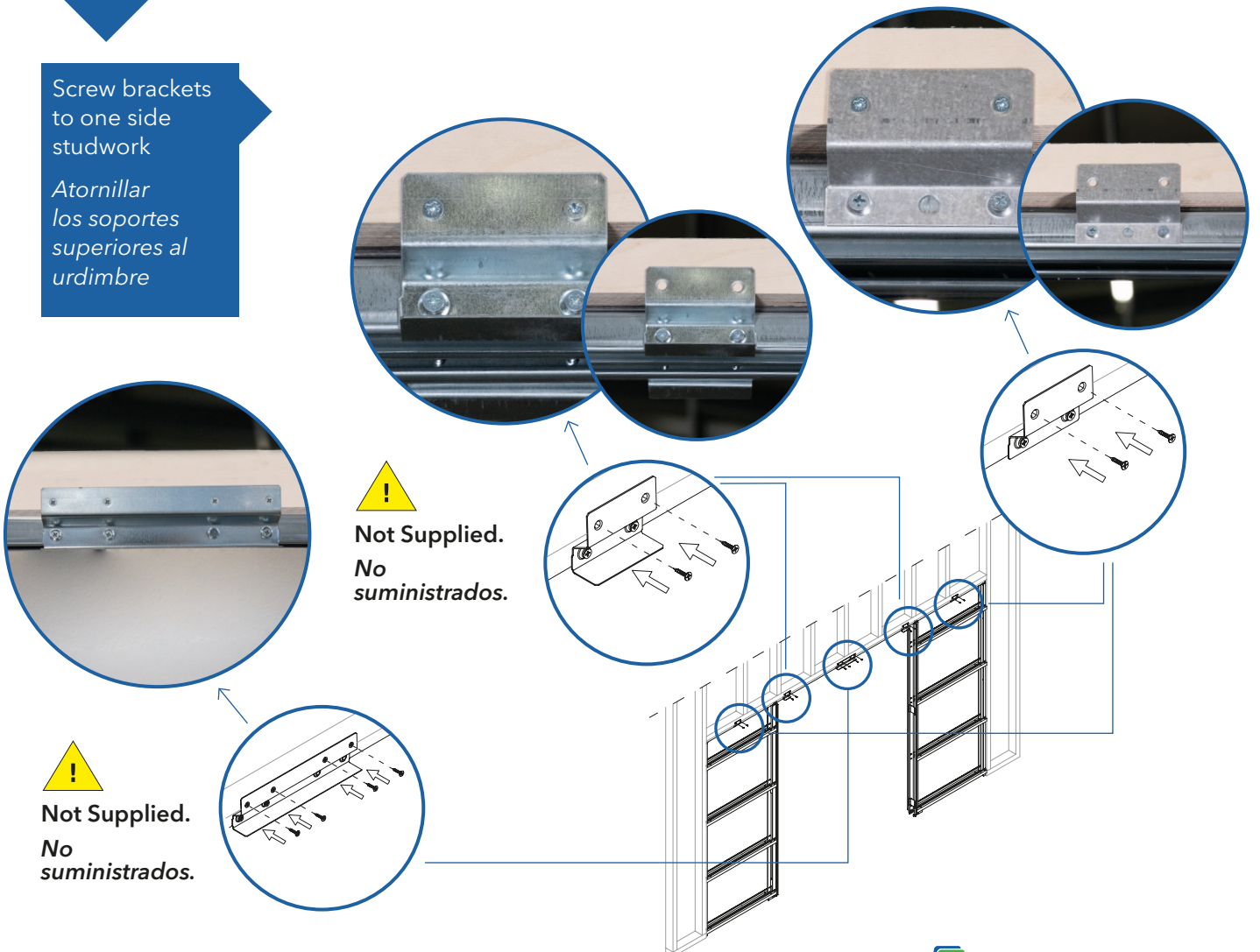

19.4

INSTALLING INTO STUDWORK INSTALACIÓN EN LA URDIMBRE

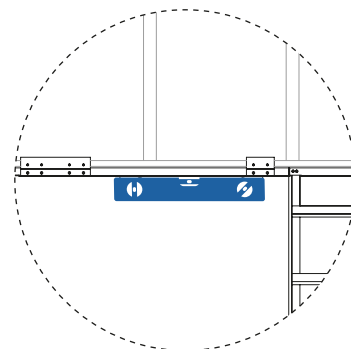
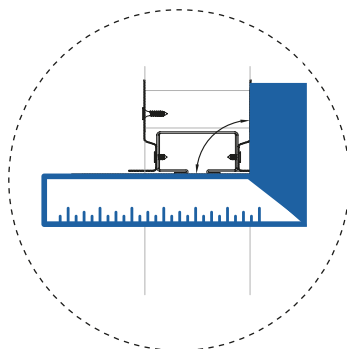
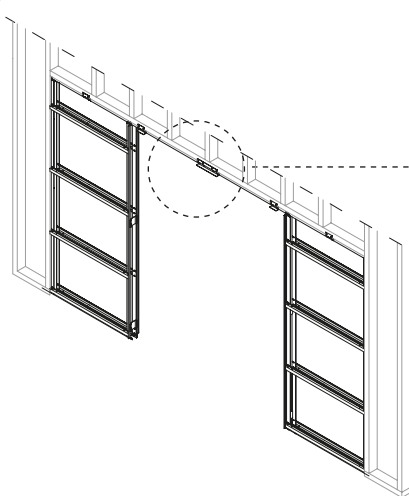

Ensure frame is plumb and square
Comprobar la plomada y la escuadra del marco

19.5

ATTACH THE BRACKET ON THE OTHER SIDE FIJAR LOS SOPORTES EN EL OTRO LADO

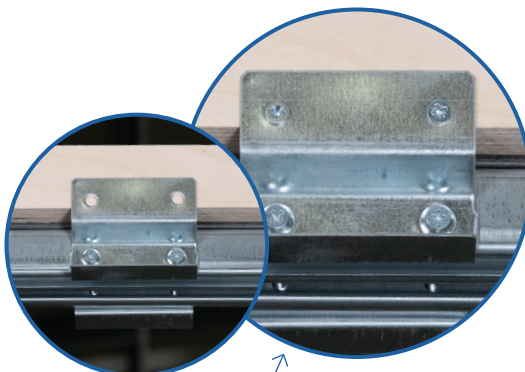
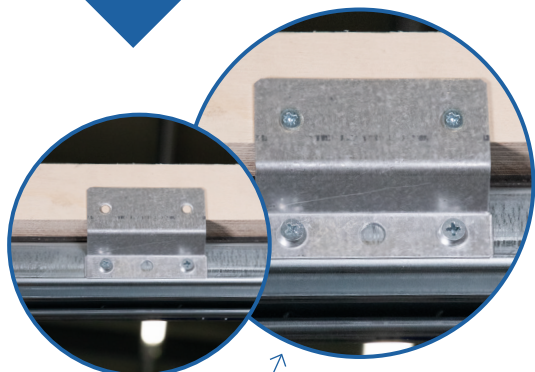

Screw brackets to the other side of studwork ensuring the frame remains level

Atornillar los soportes superiores al urdimbre aseguran que el marco se mantiene en el nivel

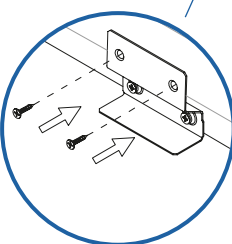
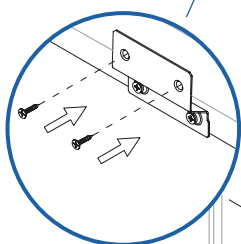

 Not Supplied.
No suministrados.

 Not Supplied.
No suministrados.

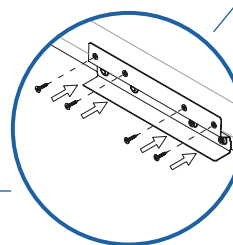
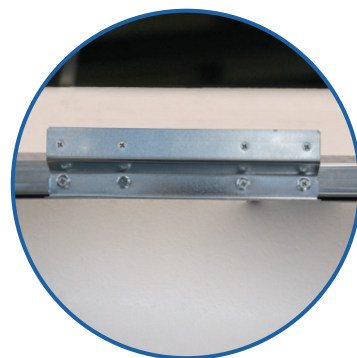

 Not Supplied.
No suministrados.

20

INSTALLING INTO STUDWORK INSTALACIÓN EN LA URDIMBRE

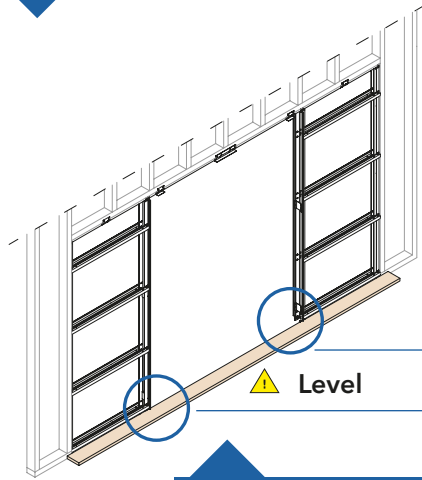

Place a straight edge along the bottom of the frame and ensure it is inline with the stud work
Coloque una regla a lo largo de la parte inferior del marco y asegúrese de que está en línea con el urdimbre

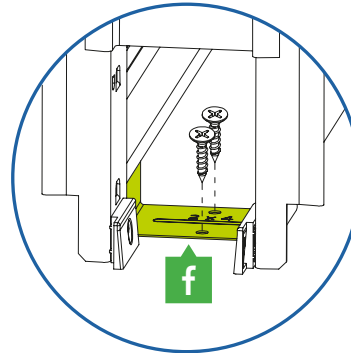

Screw the **f** brackets to the floor

*Fijar el marco al suelo a través la pletina **f***



Ensure frame is plumb and square
Comprobar la plomada y la escuadra del marco

21

ATTACH THE POCKET USING THE REAR POSTS FIJAR EL MARCO PARTE TRASERA, A TRAVÉS DEL MONTANTE DE LA URDIMBRE

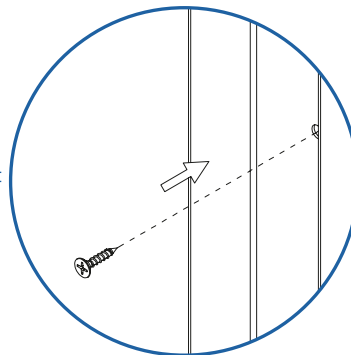
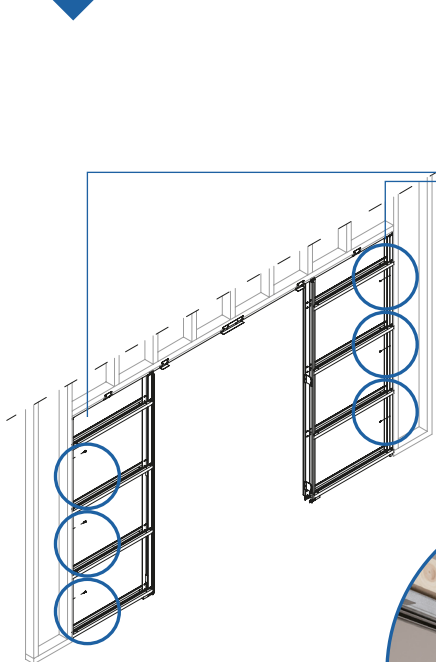

Not Supplied.
No suministrados.

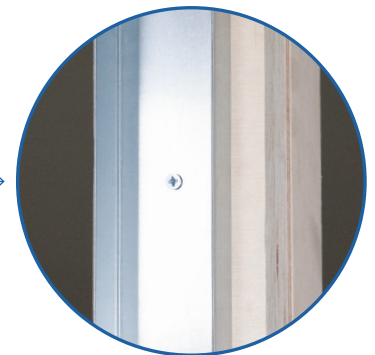

Carefully clean the tracks **once secured**
limpie con cuidado la guía una vez fijada

Screw pocket rear vertical to studwork securely
Atornillar firmemente la vertical trasera del marco al montante de la urdimbre

22

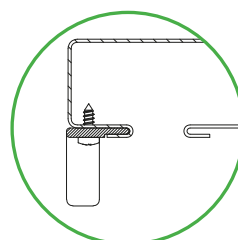
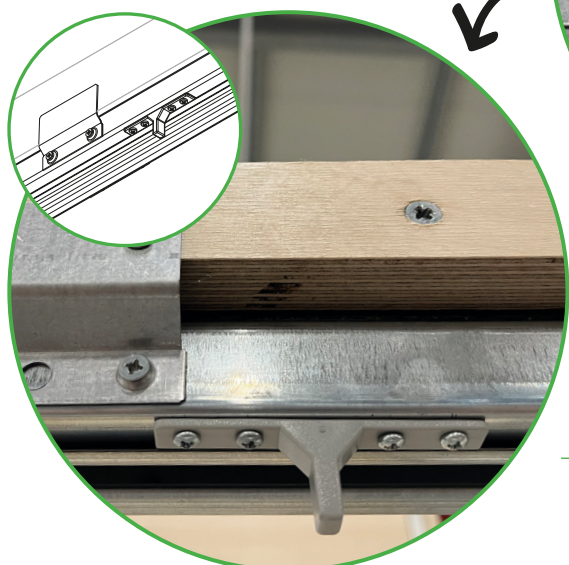
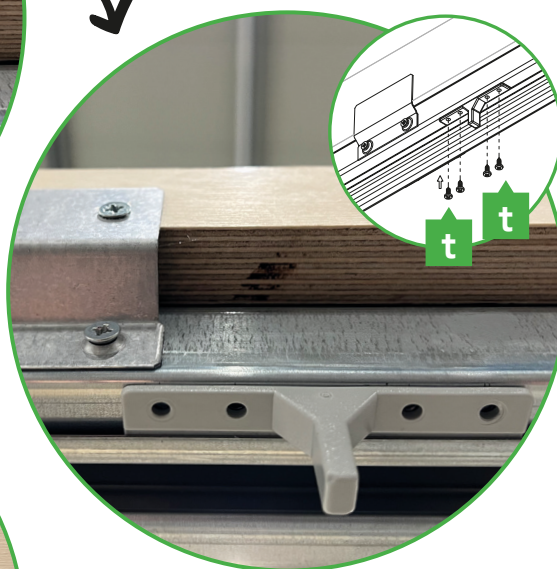
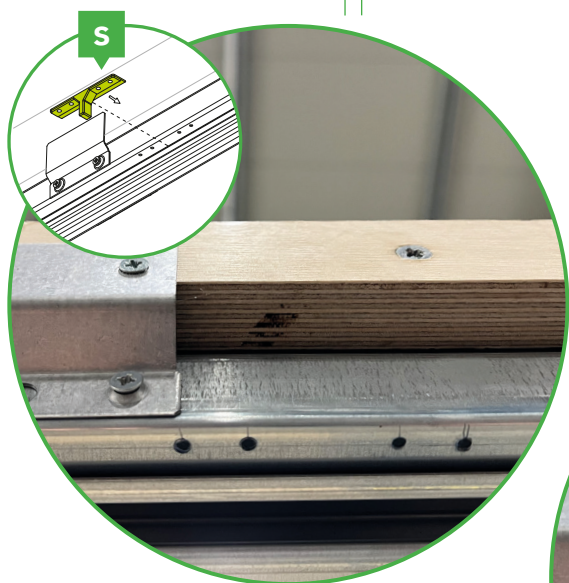
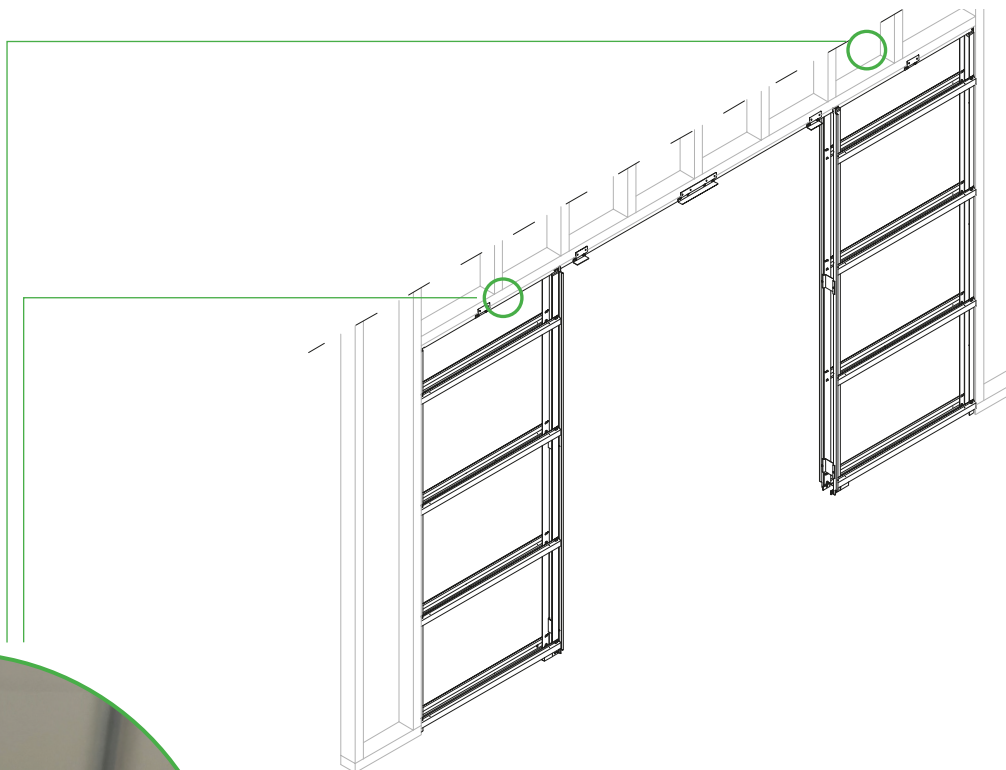
SCREW IN THE ACTIVATOR OF THE DOUBLE SLOW MOTION
ATORNILLAR EL ACTIVADOR DE LA DOBLE CÁMARA LENTA

CAUTION: if the activator is not screwed in now, it will be necessary to cut the drywall to install it later. The activator will be used to install our double slow motion in the future.

ATENCIÓN: Si el activador no se atornilla ahora será necesario cortar la placa de yeso para instalarlo más tarde. El activador se utilizará para instalar nuestro doble movimiento lento en el futuro.

23

FIXING THE DRYWALL FIJACIÓN DE LAS PLACAS DE YESO

**SINGLE DOOR
PUERTA SIMPLE**

**DOUBLE DOOR
PUERTA DOBLE**

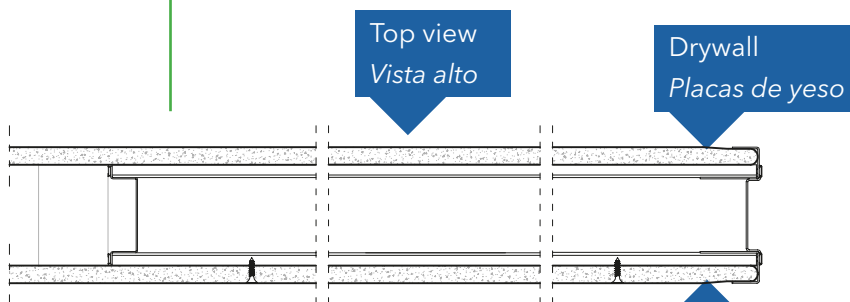
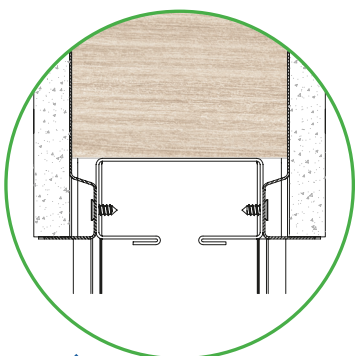
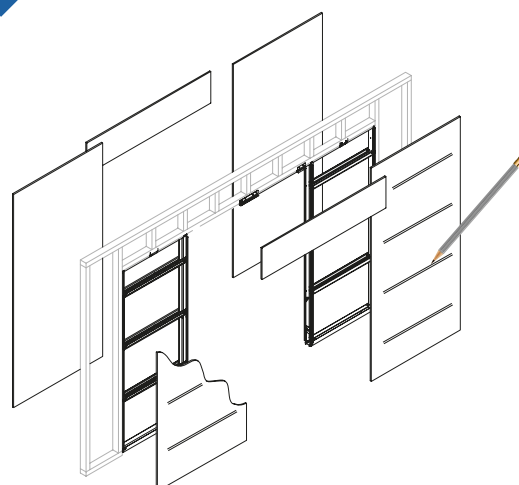
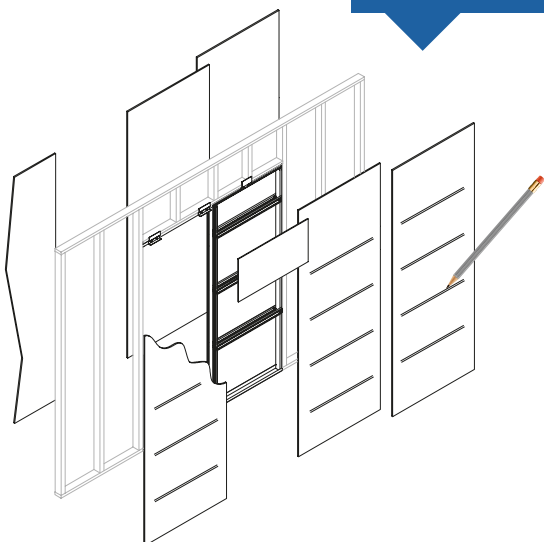

Drywall should lay on the track's brackets
Las placas de yeso tienen que apoyar en los soportes de la guía



Drywall
Placas de yeso

! Use supplied
1" (25 mm)
screws.

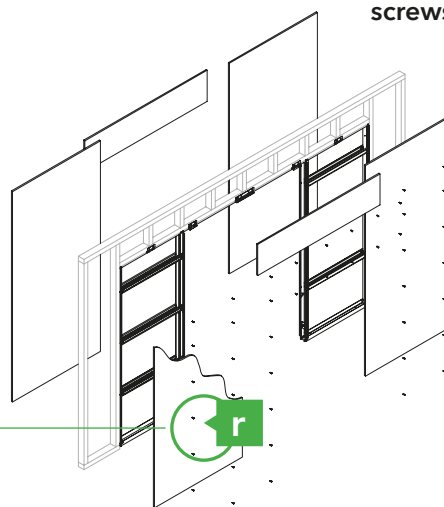
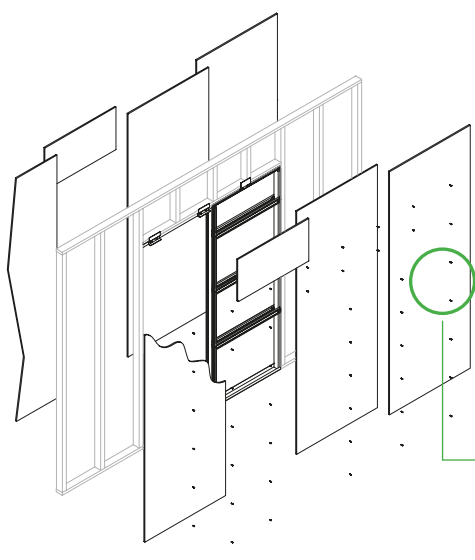

24

REMOVING SPACERS AND POLYSTERENE REMOVER LOS ESPACIADORES Y LOS POLESTILENOS

SINGLE DOOR
PUERTA SIMPLE

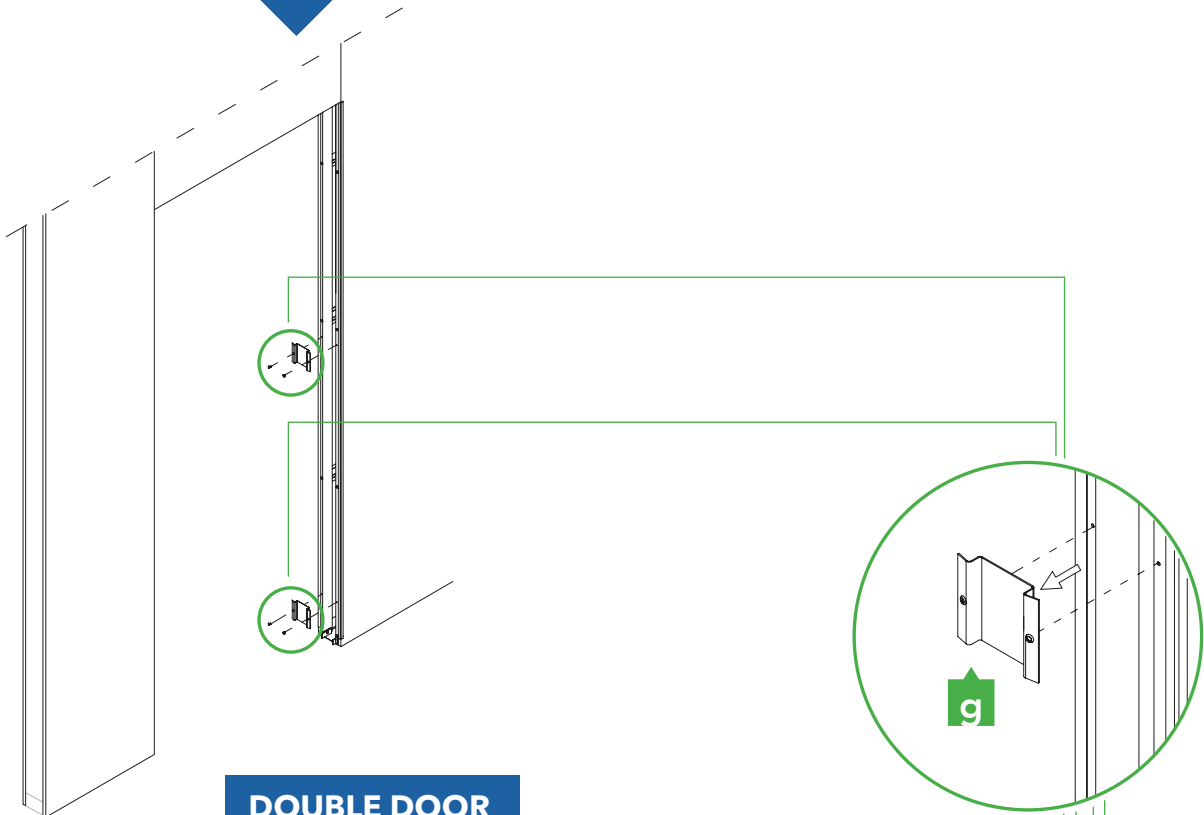

DOUBLE DOOR
PUERTA DOBLE

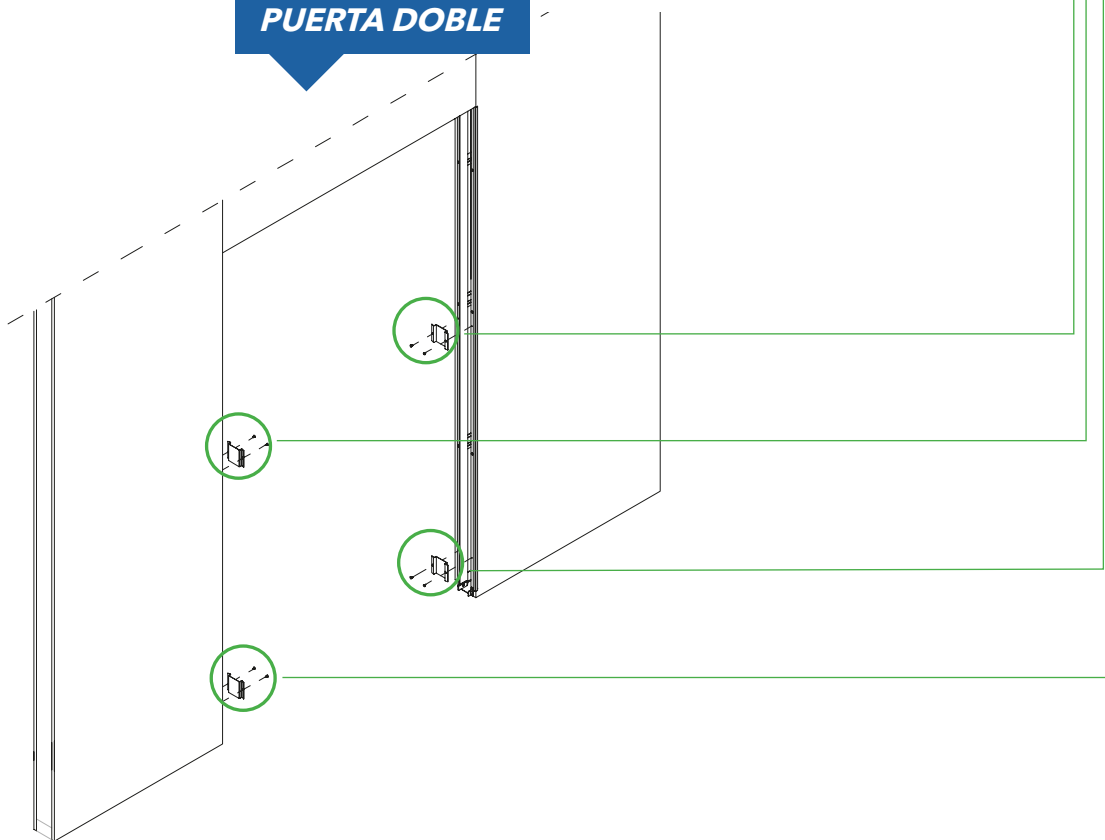

25

RUNNERS ASSEMBLING MONTAJE DE LOS CARROS DE DESLIZAMIENTO

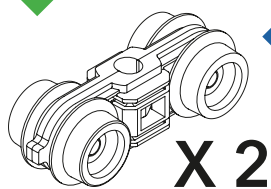

SINGLE DOOR
PUERTA SIMPLE

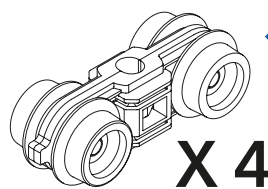

DOUBLE DOOR
PUERTA DOBLE

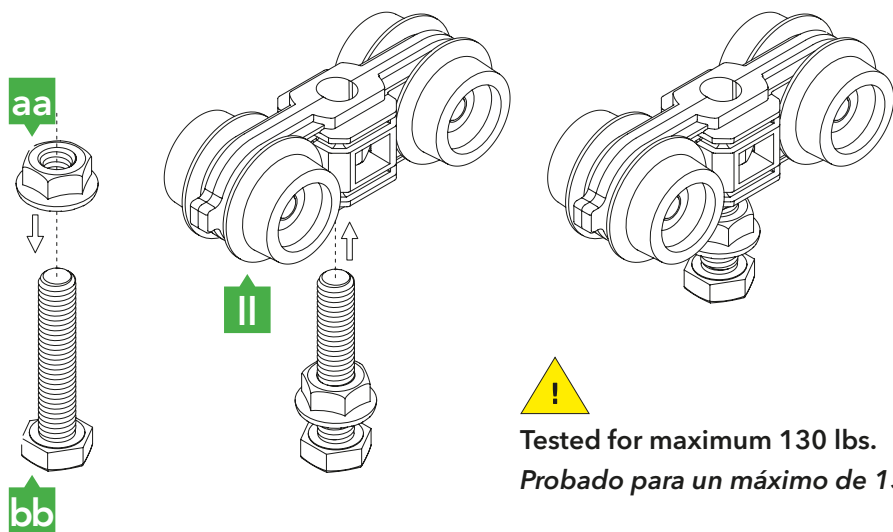

Tested for maximum 130 lbs.
Probado para un máximo de 130 lbs.

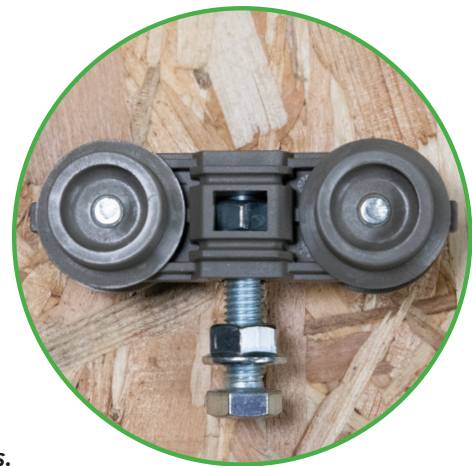

26

INSERT RUNNERS INTO TRACK INSERTAR LOS CARROS DE DESLIZAMIENTO EN LA GUIA

SINGLE DOOR
PUERTA SIMPLE

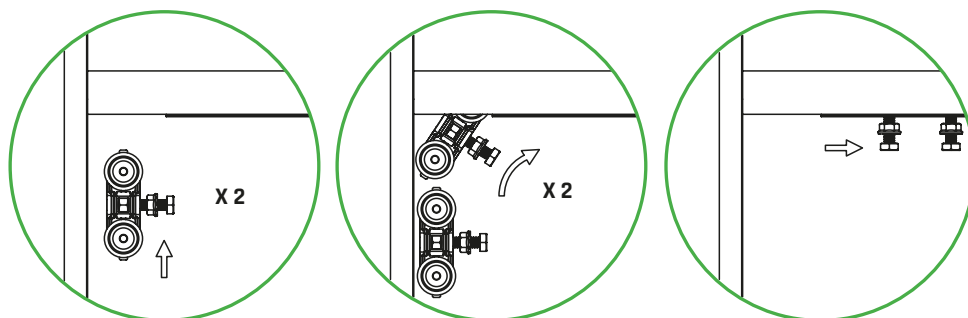

DOUBLE DOOR
PUERTA DOBLE

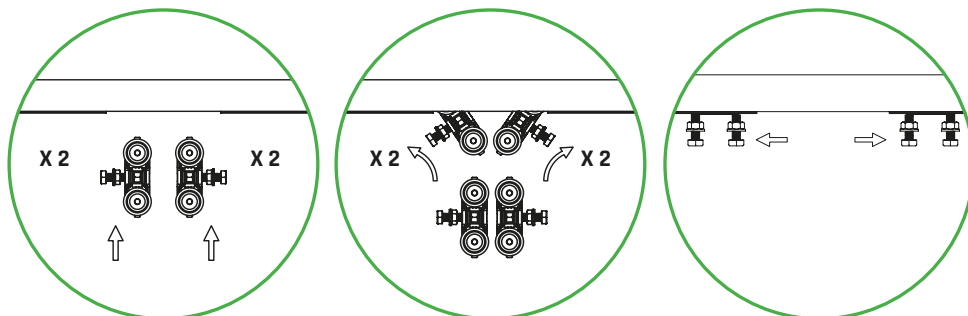

27

INSTALLING DOOR BRACKETS "hh" INSTALACIÓN DE LOS SOPORTES DE LA PUERTA "hh"

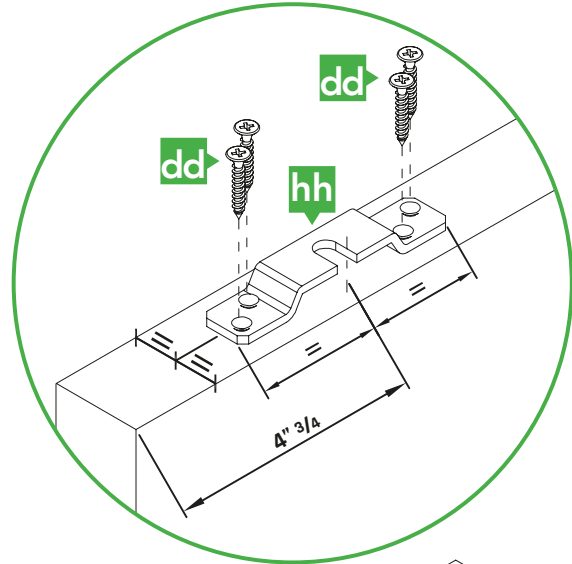

Both brackets must be installed in the same direction.

Ambos soportes deben instalarse en la misma dirección.

IMPORTANT:

for DOUBLE DOORS position front bracket on each door 3 1/2" (90 mm) instead of 4 3/4" (120 mm).

en el caso de puertas dobles coloque el soporte anterior en cada puerta a 3 1/2"(90mm) en lugar de 4 3/4"(120mm).

IMPORTANT:

if installing the soft close on a 24" door, place the rear bracket at 3-1/8".

montando el soft close en puertas de 24" coloque el soporte posterior a 3-1/8".

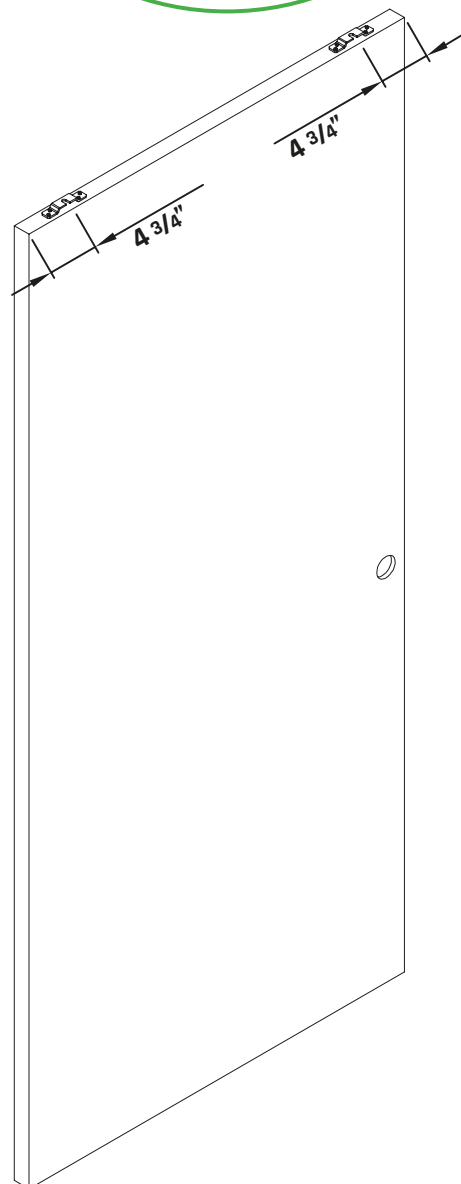

28

INSTALLING REAR DOOR BUMPER

INSTALACION DEL PARACHOQUES DE LA PUERTA TRASERA

Attach the rubber **ee** bumper to the back of the door using the supplied screw **ff**.

Coloque el parachoques de goma **ee** en la parte posterior de la puerta utilizando el tornillo suministrado **ff**.

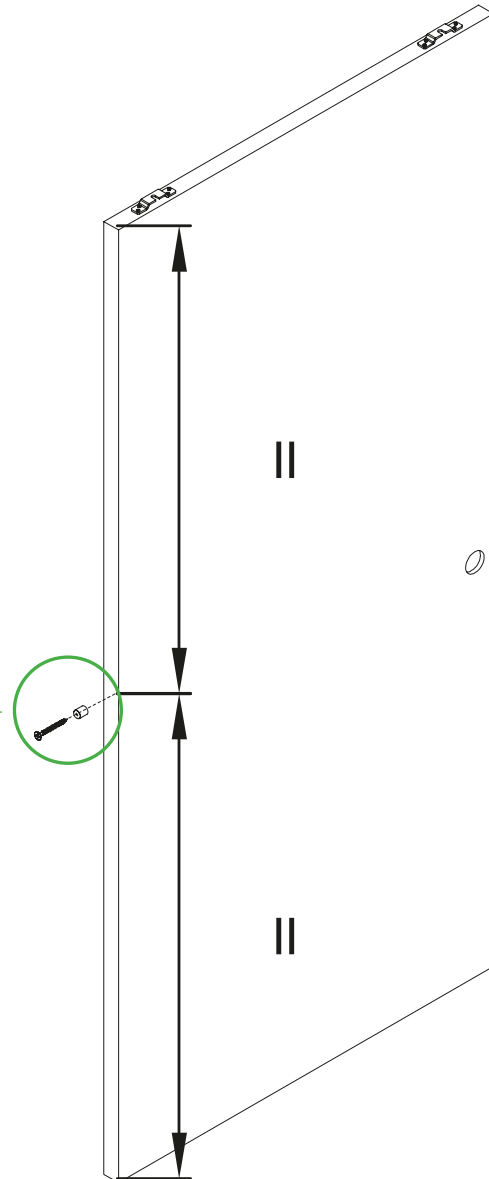
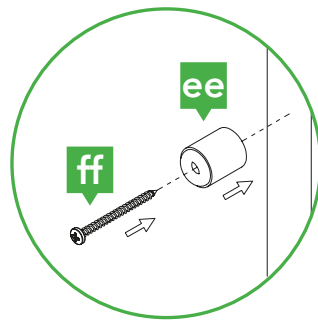

A spacer between the rear of the door and the rubber bumper is needed to protrude the door from the pocket when fully open. We recommend this with flush pulls to prevent injuries.

se necesita un espaciador entre la parte trasera de la puerta y el parachoques de goma para que la puerta sobresalga del sistema cuando esté completamente abierta. recomendamos esto con manillas enrasadas para evitar lesiones.

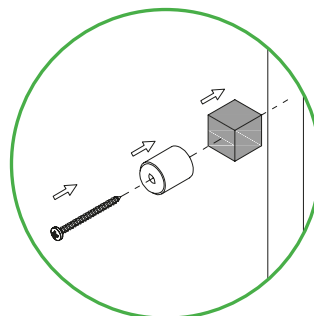

29

INSTALLING DOOR PANEL INSTALACIÓN DE LA PUERTA

**SINGLE DOOR
PUERTA SIMPLE**

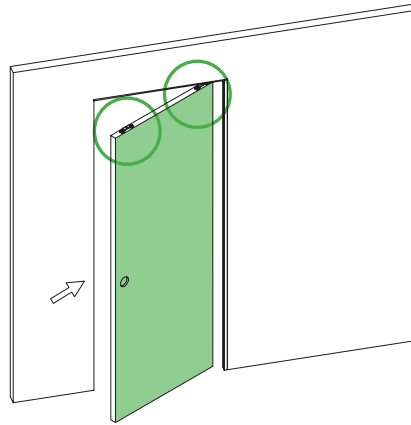

**DOUBLE DOOR
PUERTA DOBLE**

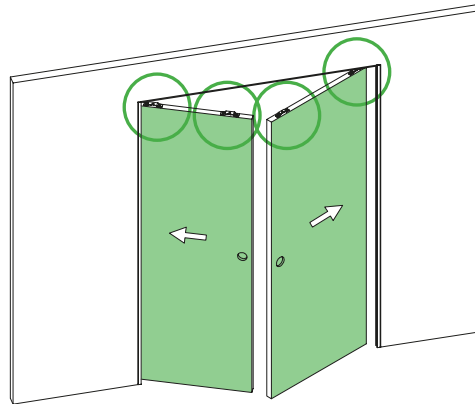

Adjust door height to be 1/4" (7 mm) above the floor and lock into position by tightening the lock nut.

Ajuste la altura de la puerta a 1/4"(7mm) sobre el suelo y bloquear en posición apretando la tuerca de seguridad.

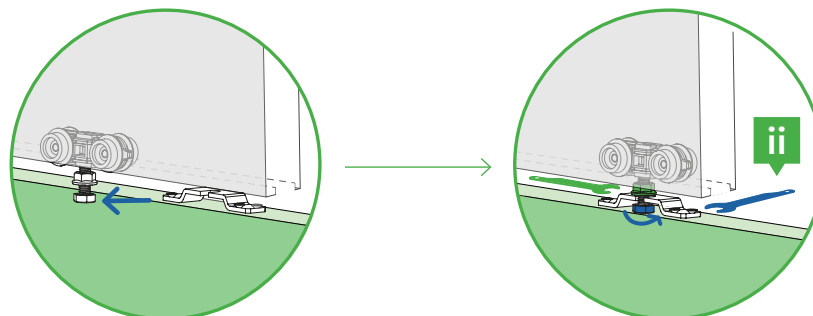

30

INSTALLING DOOR BRAKE INSTALACIÓN DEL FRENO DE LA PUERTA

SINGLE DOOR PUERTA SIMPLE

Attach the front door brake into the predrilled holes using the supplied screws.
Atornillar el freno de la puerta delantera utilizando los tornillos suministrados y los agujeros pretalados.

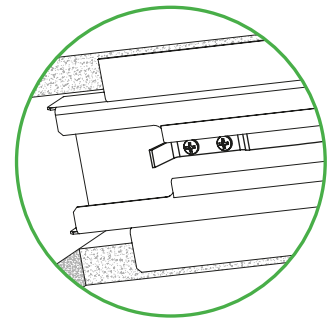
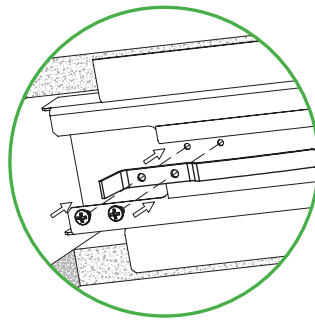
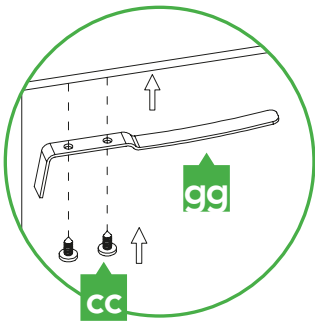
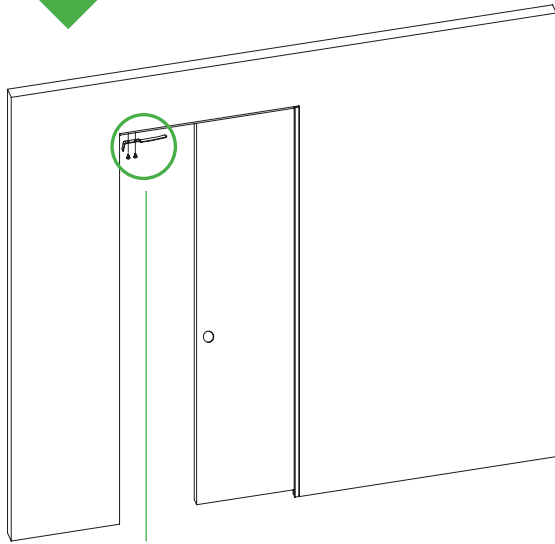

DOUBLE DOOR PUERTA DOBLE

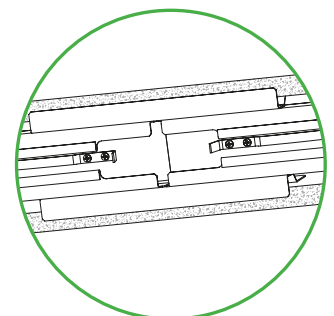
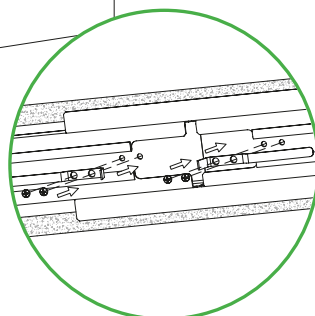
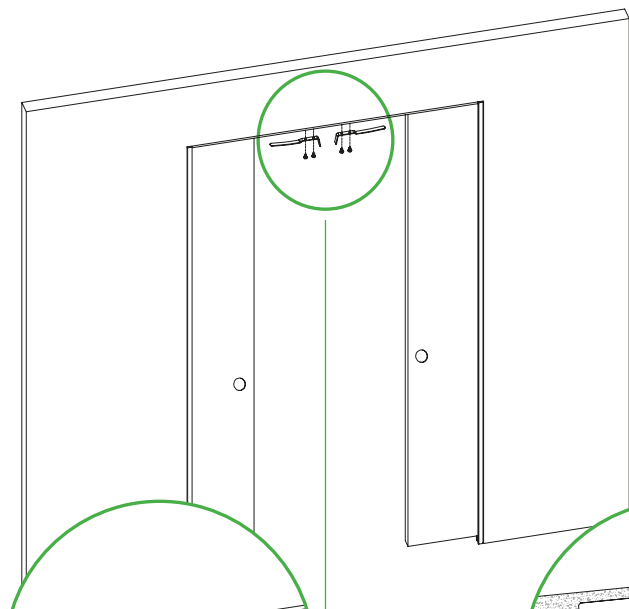

UPGRADE YOUR ROCKET POCKET WITH: MEJORA TO SISTEMA ROCKET CON:

SOFT CLOSE

The soft close is a mechanical system that will slow the door when you close it.

AMORTIGUADOR

El Amortiguador asegura un cierre blando de la puerta.

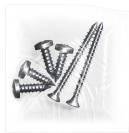

Scan the QR CODE to see the installation video

Escanee el código qr para ver el vídeo de instalación

SOFT-CLOSE AND OPEN

The soft close is a mechanical system that will slow the opening and closing of the door.

AMORTIGUADOR DOBLE

El Amortiguador asegura la apertura y el cierre suave de la puerta.



JAMBS

The jambs are specifically designed for the Rocket Pocket Door Kit, veneered with a lacquered paper ready to be painted with a color of your choice.

JUEGO DE JAMBAS

Las jambas son específicamente diseñadas para el sistema Rocket son, chapadas con papel lacado listo para ser pintado con un color de su elección.



SELF CLOSING

An easy-to-install and convenient mechanism that will automatically close a sliding pocket door.

CIERRE AUTOMÁTICO

El cierre automatico es facil de montar y es un mecanismo que permite el cierre solo de tu puerta.



Scan the QR CODE to see the installation video

Escanee el código qr para ver el vídeo de instalación



Scan the QR CODE to see the instructions

Escanee el código qr para ver el vídeo de instalación

ROCKET DOOR FRAMES ARE AVAILABLE IN THE FOLLOWING SIZES: MEJORA TO SISTEMA ROCKET CON:

POCKET DOOR FRAME

Sliding pocket door system with integral galvanized steel pocket. A quick and easy system to install using standard doors and standard 1/2" drywall. Comes complete with track integrated into the system so it always runs true.

Door Thickness: 1 3/8" - 1 3/4"

Sistema de puerta corredera empotrada con bolsillo de acero galvanizado integral. Un sistema rápido y sencillo de instalar utilizando puertas estándar y paneles de yeso estándar de 1/2". Viene completo con un riel integrado en el sistema, lo que garantiza que siempre funcione de manera precisa.

Espesor de la puerta: 1 3/8" - 1 3/4"

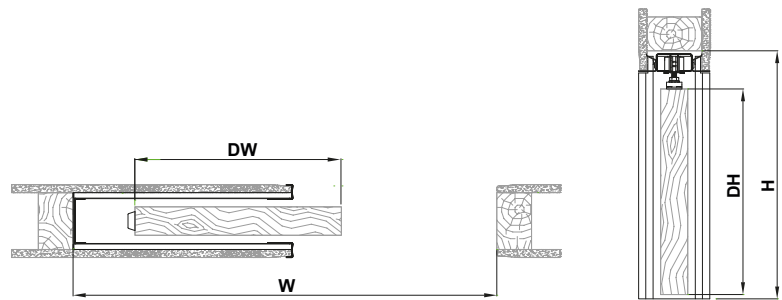

► H MEASUREMENT FROM FINISHED FLOOR LEVEL ► H MEDIDA DESDE EL NIVEL DEL SUELO ACABADO

| DOOR PANEL PANEL PUERTA | | STUD MONTANTES | OVERALL DIMENSIONS MEDIDA TOTAL | | | |
|----------------------------|-----|-------------------|------------------------------------|---------|-----------------------------|---------|
| DW | DH | | SINGLE DOOR PUERTA ÚNICA | | DOUBLE DOOR PUERTA DOBLE | |
| DW | DH | | W | H | W | H |
| 24" | 80" | 2x4 | 48 5/8" | 82 3/4" | 97 1/4" | 82 3/4" |
| 28" | 80" | 2x4 | 56 1/4" | 82 3/4" | 112 5/8" | 82 3/4" |
| 30" | 80" | 2x4 | 60 3/8" | 82 3/4" | 120 3/4" | 82 3/4" |
| 32" | 80" | 2x4 | 64 3/8" | 82 3/4" | 128 3/4" | 82 3/4" |
| 34" | 80" | 2x4 | 68 3/8" | 82 3/4" | 136 3/4" | 82 3/4" |
| 36" | 80" | 2x4 | 72 1/4" | 82 3/4" | 144 5/8" | 82 3/4" |
| DW | DH | | W | H | W | H |
| 24" | 84" | 2x4 | 48 5/8" | 86 3/4" | 97 1/4" | 86 3/4" |
| 28" | 84" | 2x4 | 56 1/4" | 86 3/4" | 112 5/8" | 86 3/4" |
| 30" | 84" | 2x4 | 60 3/8" | 86 3/4" | 120 3/4" | 86 3/4" |
| 32" | 84" | 2x4 | 64 3/8" | 86 3/4" | 128 3/4" | 86 3/4" |
| 34" | 84" | 2x4 | 68 3/8" | 86 3/4" | 136 3/4" | 86 3/4" |
| 36" | 84" | 2x4 | 72 1/4" | 86 3/4" | 144 5/8" | 86 3/4" |
| DW | DH | | W | H | W | H |
| 24" | 96" | 2x4 | 48 5/8" | 98 3/4" | 97 1/4" | 98 3/4" |
| 28" | 96" | 2x4 | 56 1/4" | 98 3/4" | 112 5/8" | 98 3/4" |
| 30" | 96" | 2x4 | 60 3/8" | 98 3/4" | 120 3/4" | 98 3/4" |
| 32" | 96" | 2x4 | 64 3/8" | 98 3/4" | 128 3/4" | 98 3/4" |
| 34" | 96" | 2x4 | 68 3/8" | 98 3/4" | 136 3/4" | 98 3/4" |
| 36" | 96" | 2x4 | 72 1/4" | 98 3/4" | 144 5/8" | 98 3/4" |

